

VISTA-128FBPN

Commercial Fire and Burglary Partitioned Security System with Scheduling

Programming Guide

Table of Contents

Programming Field Settings for UL864 Compliance 2	Relay Voice Descriptors and Custom Word
Recommended Programming Procedure..... 8	Substitutes Vocabulary..... 43
Program Field Index 9	System Layout Worksheets..... 45
VISTA-128FBPN Programming Form 10	Output Devices Worksheets 57
Partition-Specific Fields..... 16	Scheduling Menu Prompts 63
Programming With #93 Menu Mode 18	Scheduling Worksheets..... 64
5800 Series Transmitters Loop Designations 23	
Alpha Descriptor Vocabulary..... 33	

Programming Field Settings for UL864 Compliance

NOTICE TO USERS, INSTALLERS, AUTHORITIES HAVING JURISDICTION, AND OTHER INVOLVED PARTIES			
This product incorporates field-programmable software. In order for the product to comply with the requirements in the Standard for Control Units and Accessories for Fire Alarm Systems, UL 864, certain programming features or options must be limited to specific values or not used at all as indicated below.			
Program feature or option	Permitted in UL864? Y/N	Possible settings	Settings permitted in UL 864
*08 TEMPORAL SIREN PULSE	N	0 = disable 1 = enable	Not used at this time. Must be set to "0" (disable).
*13 ALARM SOUNDER (BELL) TIMEOUT	Y	Enter 01-15 multiplied by 2 minutes. 00 = no timeout.	Must be set to "3" (Minimum of 6 minutes).
*14 TRIGGER OR RS232	N	0 = trigger 1 = RS232 input	Must be set to "0".
*17 AC LOSS KEYPAD SOUNDING	N	0 = disable 1 = enable	Must be set to "1" (enabled).
20 VIP MODULE PHONE CODE	N	Enter 01 - 09 for the first digit; enter 11 for "" or 12 for "#" for the second digit.	Not used. Must be set to "00".
*22 KEYPAD PANIC ENABLES (PARTITION SPECIFIC)	N	0 = disable 1 = enable	Must be set to "000" for partition 1 in fire systems.
*26 INTELLIGENT TEST REPORTING	N	0 = disable 1 = enable	Must be set to "0" (disable).
*27 TEST REPORT INTERVAL	Y	Enter 0001-9999 for the test report interval in hours. Enter 0000 for test reporting.	Must be set to "0024" (Maximum 24 hours)
*28 POWERUP IN PREVIOUS STATE	Y	0 = disable 1 = enable	Must be set to "1" (enable).
*37 DOWNLOAD COMMAND ENABLES	N	0 = disable 1 = enable	Must be set to "0" for all entries (disable).
*41 NORMALLY CLOSED OR EOLR (ZONES 3-8)	N	0 = EOLR supervision 1 = N.C. loops	Must be set to "0" (EOLR Supervision).
*42 DIAL TONE PAUSE	Y	Enter the wait time for dial tone detection: 0 = 5 seconds; 1 = 11 seconds; 2 = 30 seconds.	Must be set to "0" (5 seconds).
*44 RING DETECTION COUNT	N	Enter 00 to disable ring detection. Enter 01-14 for ring counts of 1-14. Enter 15 to select Answering Machine Defeat Mode	Must be set to "00" (disable).

Program feature or option	Permitted in UL864? Y/N	Possible settings	Settings permitted in UL 864
*54 UNATTENDED MODE	N	0 = disable 1 = enable	Must be set to "0" (disable).
*56 DYNAMIC SIGNALING DELAY	Y	Enter 00-15 times 15 seconds.	Must be set to "6" (90 seconds).
*77 AUTO TROUBLE RESTORE	Y	0 = disable 1 = enable	Must be set to "1" (enable).
*80 ZONE TYPE RESTORES FOR TYPES 9, 10 & 14	N	0 = disable 1 = enable	Must be set to "1" (enable) for zone type 9.
1*12 PROGRAM NOTIFICATION SIGNAL	Y	0 = no 1 = yes	Must be set to "1" (yes).
1*13 SYSTEM SENSOR REVERSING RELAY	N	0=use neither Zone 1 or Zone 2 inputs 1=use Zone 1 input; 2=use Zone 2 input; 3=use Zone 1 and Zone 2 inputs.	Not Used. Must be set to "0".
1*18 AFFECTS LOBBY	N	0 = disable 1 = enable	Must be set to "0" (disabled) for partition 1.
1*19 ARMS LOBBY	N	0 = disable 1 = enable	Must be set to "0" (disabled) for partition 1.
1*22thru 1*25 CROSS-ZONING PAIRS (1 – 4)	N	Enter 001-128 Enter 000,000 to disable	Must be set to "000,000" (disabled) for fire zones.
1*28 RF TRANSMITTER LOW BATTERY SOUND	N	0 = disarmed state only 1 = both armed and disarmed states	Must be set to "1" (both armed and disarmed states).
1*29 RF TRANSMITTER LOW BATTERY REPORTING	N	0 = disable 1 = enable	Must be set to "1" (enable).
1*30 RF RECEIVER SUPERVISION CHECK-IN INTERVAL	N	Enter 02–15 times 2 hours (4–30 hours) Enter 00 to disable receiver supervision	Maximum is 02 (4 hours) for fire installations.
1*31 RF TRANSMITTER CHECK-IN INTERVAL	N	Enter 02–15 times 2 hours (4–30 hours) Enter 00 to disable transmitter supervision	Maximum is 02 (4 hours) for fire installations.
1*35 ACCESS CONTROL DIALER ENABLES	N	0 = disable 1 = enable	Not used. Must be set to "0".
1*44 WIRELESS KEYPAD TAMPER DETECTION	N	0 = disable 1 = enable	Not used. Must be set to "0".
1*48 WIRELESS KEYPAD ASSIGNMENT	N	0 = none 1-8 = partition number	Not used. Must be set to "0".
1*49 SUPPRESS TX SUPERVISION SOUND	N	0 = disable 1 = enable	Must be set to "0" (disable).
1*53 DISABLE DOWNLOAD CALLBACK	N	0 = callback required 1 = no callback required	Must be set to "0" (callback required).
1*57 5800 RF BUTTON GLOBAL ARM	N	0 = disable 1 = enable	Must be set to "0" (disable).
1*58 5800 RF BUTTON FORCE ARM	N	0 = disable 1 = enable	Must be set to "0" (disable).
1*60 ZONE 5 AUDIO ALARM VERIFICATION	N	0 = disable 1 = enable	Must be set to "0" (disable).
1*72 EVENT LOG PRINTER ONLINE	N	0 = disable 1 = enable	Not used. Must be set to "0".
1*73 PRINTER BAUD RATE	N	0 = 1200 1 = 300	Not used.
1*76 CONTROL RELAY (PART-SPECIFIC)	N	01-96 = relay number 00 = relay not used.	Must be set to "00" (relay not used) for partition 1.
1*78 EXTENDED HOME CONT EVENTS	N	1 = extended 0 = limited	Not used. Must be set to "0".
1*79 HOME CONTROL EVENTS	N	0 = disable 1 = enable	Not used. Must be set to "0" in each entry.
2*07 AUTO-DISARM DELAY (PART SPECIFIC)	N	00 = no delay. 01-14 times 4 minutes (04-56) delay. 15 = no auto disarming.	Must be set to "15" (no auto disarming) for partition 1.

Program feature or option	Permitted in UL864? Y/N	Possible settings	Settings permitted in UL 864
2*18 ENABLE GOTO FOR THIS PARTITION (partition-specific)	N	0 = disable 1 = enable	Must be set to "0" (disable) for partition 1.
2*21 SUPERVISION PULSES FOR COMMUNICATIONS DEVICE	N	0 = disable 1 = enable	Not used. Must be set to "00000" (disable).
2*22 DISPLAY FIRE ALARMS OF OTHER PARTITIONS	N	0 = disable 1 = enable	Must be set to "0" (disable) for partition 1.
2*23 DISPLAY BURGLARY, PANIC AND CO ALARMS FOR OTHER PARTITIONS	N	0 = disable 1 = enable	Must be set to "0" (disable) for partition 1.
2*24 DISPLAY TROUBLES OF OTHER PARTITIONS	N	0 = disable 1 = enable	Must be set to "0" (disable) for partition 1.
3*01 EVENTS DISPLAY LOCK	N	0 = disable 1 = enable	Must be set to "1" (enable).
3*12 ZN TYPE 18 DELAY USE	N	0 = disable 1 = enable	Must be set to "0" (disable).
3*13 FIRE SUPERVISORY RESPONSE TO OPEN/SHORT (APPLIES TO ZONE TYPE 18)	N	0 = Trouble on open/Supv on short 1 = Supv on open/Supv on short	Must be set to "0".
3*14 WATERFLOW ALARM SILENCE OPTION	N	0 = Silenced by User Code + OFF 1 = Silenced when zone restores	Must be set to "0" (Silenced by User Code + OFF).
3*16 DELAY FOR ZONE TYPES 17 & 18 (Waterflow/Supervisory)	N	Enter 01-15 times 2 seconds Enter 00 for no delay	Must be set to 00 (no delay).
3*18 EXTENDED DELAY FOR ZONE TYPES 17 & 18 Multiplies delay in 3*16 x 4)	N	0 = no extended delay 1 = multiply delay by 4	Must be set to 0 (no extended delay).
3*19 AUXILIARY INPUT ALTERNATE FUNCTION ENABLE	N	0 = disable 1 = enable	Must be set to 0 (disable).
3*20 TRIGGER OUTPUTS FUNCTION SELECTION	N	0 = remote keypad sounder 1 = keyswitch LEDs	Must be set to 0 (remote keypad sounder).
3*21 MAXIMUM NUMBER OF DIALER ATTEMPTS	Y	1-8	Must be set at 3, 4 or 5.
3*50 ZONE TYPE RESTORE ENABLES FOR TYPES 16-18	N	0 = disable 1 = enable	Must be set to "1" (enable).
3*55 RESET ON SECOND OFF FOR BELL 1	N	0 = disable 1 = enable	Must be set to "0" (disable).
3*56 RESET ON SECOND OFF FOR BELL 2	N	0 = disable 1 = enable	Must be set to "0" (disable).
3*57 BELL 2 AND AX RELAY CONFIRM ARMING DING	N	0 = disable 1 = enable	Must be set to "0, 0" (disable).
3*59 ENABLE BELL 2 & AUXILIARY RELAY CHIME ANNUNCIATION	N	0 = disable 1 = enable	Must be set to "0" (disable) if Bell 2 or Aux Relay is used for Fire.
3*60 BELL 2 & AUX RELAY TIMEOUT	Y	Enter 01-15 multiplied by 2 minutes. 00 = no timeout.	Must be set to "3" (Minimum of 6 minutes).
3*82 BURGLARY FEATURES ON PARTITION 1 ENABLE	N	0 = disable 1 = enable	Must be set to "0" (disable).
RESTRICTION FOR FIRE RELAYS	Y	Yes No	Restriction for # 70 must be set to Yes when programming fire relays.

NOTE: When there is a conflict between UL864 and CP-01, UL864 will take precedence.

SIA CP-01 Quick Reference Chart

The minimum required system for SIA CP-01 is a UL Listed Control, Keypad and Bell.

Item	Feature	Range	Shipping Default	SIA Requirement*
*09	Entry Delay # 1	02 – 15 multiplied by 15 seconds 00 = 240 sec (4 minutes)	30 Seconds`	At least 30 Seconds **
*10	Exit Delay #1	03 – 15 multiplied by 15 seconds	60 Seconds	60 Seconds
*11	Entry Delay # 2	02 – 15 multiplied by 15 seconds 00 = 240 sec (4 minutes)	30 Seconds	At least 30 Seconds **
*12	Exit Delay #2	03 – 15 multiplied by 15 seconds	60 Seconds	60 Seconds
*28	Power Up in Previous State	0 = no 1 = yes	Yes	Yes
*57	Dynamic Signaling Priority	0 = primary dialer 1 = Communicator as first reporting destination	0 (primary dialer)	0 (primary dialer)
*84	Swinger Suppression	01= 1 alarm 02= 2 alarms	1 alarm	1 alarm
*88	Abort Window Time (for non-fire zones)	1 = 15 seconds 2 = 30 seconds 3 = 45 seconds	30 Seconds	At least 15 Seconds **
1*21	Exit Time Reset	0=no 1=Resets Exit Delay to programmed value after zone is closed and then faulted prior to end of exit delay.	1 (Enabled)	1 (Enabled)
1*22 – 1*25	Cross Zoning	Zone 001 – 128 000, 000 = Disabled	Disabled	Enabled and two (or more) zones programmed
1*42	Call Waiting Defeat	0 = no 1 = yes	Disabled (0)	Enabled if user has call waiting
1*61	Abort Verify	0 = Disable 1 = Enable	Enabled	Enabled
Zone Programming Auto Stay Zone, Zone type 04 has this feature enabled by default	Auto Stay Arm or Occupied Premises	0 = Disable 1 = Enable	1 (Enabled)	Enabled
Zone Programming (Abort Window Enable)	Abort Window (for non-fire zones)	0 = no abort window 1 = yes, use abort window according to *88 selection	1 = yes	Yes (all non-fire zones)

Zone Programming (Swinger Suppression Enable)	Swinger Suppression Enable	0 = no suppression 1 = yes, suppress alarms according to *84 selection	Yes (enabled)	Yes (enabled (all zones))
Item	Feature	Range	Shipping Default	SIA Requirement*
Zone Programming Tamper Option	Fire Alarm Verification	For Zone Response Type 16 (Fire) tamper selection must be set to "0"	Disabled	Enabled unless sensors can self verify
-	Exit Time and Progress Annunciation/Disable for Remote Arm (Not Evaluated for SIA CP-01)	Always Enabled	Enabled	Enabled
-	Cancel Window	5 minutes	Enabled	Not required to be programmable
-	Cancel Annunciation - Keypad displays "Alarm Cancel" when report is received	NA	Enabled	Enabled
-	Programmable Cross Zoning Time	Both zones must be faulted within 5 minutes	Per Manufacturer	Per walk path in protected premises
User Authority Level 6	Duress Feature	NA	Disabled	Disabled

* Programming at installation may be subordinate to other UL requirements for the intended application.

** In accordance with UL standards, the combined Entry Delay time and Abort Window cannot exceed 1 minute.

The purpose of this document is to provide a quick and easy way to program your entire system. A recommended programming procedure is included, followed by a list of program fields with the corresponding program group they belong to (system-wide, partition-specific, scheduling, etc.). Two program forms are included. One contains all the programming fields, and the other contains the partition-specific fields. If you are setting up a single-partition system, the partition-specific fields become system-wide fields.

Following the program forms are system layout worksheets. We recommend that you use these sheets to plan your system before programming is performed. If you need further information about specific programming options, see the *VISTA-128FBPN Installation and Setup Guide*.

Make sure that one two-line alpha keypad is connected to the control and is set to device address "00."

Single-Partition System

The system default is for a single-partition system. Use the VISTA-128FBPN SINGLE PARTITION PROGRAMMING FORM when programming for single-partition usage. Follow the steps outlined in RECOMMENDED PROGRAMMING PROCEDURE of this document for proper programming procedure.

Multiple-Partition System

You must enter the number of partitions you are using in data field 2*00 to set the system for multiple partitions. Use the VISTA-128FBPN SINGLE PARTITION and the PARTITION-SPECIFIC PROGRAM FORMS when programming the system for multiple partitions. Follow the steps outlined in RECOMMENDED PROGRAMMING PROCEDURE of this document for proper programming procedure.

SUMMARY OF PROGRAMMING COMMANDS

- **To enter program mode**, enter installer code + [8] + [0] + [0] + [0]
- **To set standard defaults**, press *97
- **To change to next page of program fields**, press *94
- **To return to previous set of fields**, press *99
- **To erase account and phone number field entries**, press [*] + field number + [*]
- **To assign zone descriptors**, press #93 + follow menu prompts
- **To add custom words**, press #93 + follow menu prompts
- **To enter Installer's Message**, press #93 + follow menu prompts
- **To exit program mode**, enter *99 OR *98: *99 allows re-access to programming mode by installer code. *98 prevents re-access to programming mode by installer code. The only way to re-access programming mode is by depressing both the [*] and [#] keys at the same time within 30 seconds of power-up.

Standard default (*97) values are shown in brackets [], otherwise default = 0.

Recommended Programming Procedure

The following is a step-by-step procedure recommended for programming your VISTA-128FBPN system.

1. Set the keypads (and other peripheral devices) to the appropriate addresses.

2. Set factory defaults by pressing *97.

This will automatically enable keypad addresses 00-01, so be sure at least one keypad is set to one of these addresses.

3. Program system-wide (global) data fields.

Using the programming form as a guide, enter program mode and program all system-wide programming fields. These options affect the entire system, regardless of partitions. They include control options, downloader and dialer options, RF options, event logging options, etc. Refer to the *Program Field Index* for a listing of the program fields and their function.

Note that field 2*00 (number of partitions) must be programmed before continuing.

4. Program partition-specific fields.

When the system-wide fields have been programmed, program all partition-specific programming fields by first pressing *91 to select a partition (while still in data field program mode). Then enter the first partition-specific field number *09. When you are finished, the next partition-specific field is automatically displayed. Partition-specific fields can have different values for each partition. To program the fields for the next partition, press *91, enter the desired partition number, then enter field *09. Refer to the *MECHANICS OF PROGRAMMING* section in the *VISTA-128FBPN Installation and Setup Guide* for detailed instructions.

5. Use #93 Menu Mode for device programming.

Refer to *Device Programming* in this guide to assign keypad ID numbers and default partitions for each keypad, and to selectively suppress certain keypad sounding options. Also use this mode to assign RF receivers, relay modules, and Communicators (7845i-ent, 7845i-GSM, 7845GSM).

6. Use #93 Menu Mode for zone programming.

Refer to *Zone Programming* in this guide to program zone response types, assign right loop zones and wireless zones, assign zones to partitions, and to program alarm report codes.

7. Use #93 Menu Mode for programming outputs.

Refer to *Output Programming* in this guide to program desired output operation.

8. Program Communication options.

Refer to *System Communication* section in the *VISTA-128FBPN Installation and Setup Guide* for detailed instructions. Then use #93 menu mode to program report codes.

9. Use #93 Menu Mode for programming alpha descriptors.

Refer to *Alpha Programming* in this guide to enter zone and partition descriptors and a custom installer's message.

10. Use #80 Mode for programming schedules.

Refer to the *Scheduling Menu Prompts* in the *VISTA-128FBPN Installation and Setup Guide* to program open/close schedules, temporary and holiday schedules, limitation of access schedules, and time-driven events.

11. Define user access codes.

Refer to *User Access Codes* in the *VISTA-128FBPN Installation and Setup Guide* to program authority level, O/C reporting option, partition assignments, and wireless key assignments for each user.

12. Exit Programming Mode.

Exit programming mode by pressing either *98 or *99. Additional entries of *99 are required if the exit is being done from fields 1*00 and above.

To prevent re-access to programming mode using the Installer's code, use *98. The only way to re-access programming mode is by depressing both the [*] and [#] keys at the same time within 30 seconds of power-up.

Exiting by using *99 always allows reentry into programming mode using the Installer code. Either way of exiting allows access via downloading. Note that if local programming lockout is set via downloading, programming mode cannot be entered at the keypad.

Program Field Index

On the following pages, the programming fields have been arranged in numerical order. Use this index to cross-reference the fields on the programming form.

Field	Group
*00	System-Wide
*04	System-Wide
*05	System-Wide
*06	Partition-Specific
*08	System-Wide
*09	Partition-Specific
*10	Partition-Specific
*11	Partition-Specific
*12	Partition-Specific
*13	Partition-Specific
*14	System-Wide
*15	System-Wide
*16	Partition-Specific
*17	System-Wide
*19	System-Wide
*20	System-Wide
*22	Partition-Specific
*24	System-Wide
*25	System-Wide
*26	Communications
*27	Communications
*28	System-Wide
*29	Partition-Specific
*30	Communications
*31	Communications
*32	Partition-Specific
*33	Communications
*34	Communications
*35	System-Wide
*36	System-Wide
*37	System-Wide
*38	Partition-Specific
*39	Partition-Specific
*40	Communications
*41	System-Wide
*42	Communications
*43	Communications
*44	Communications
*45	Communications
*46	Communications
*47	Communications
*48	Communications
*49	Communications
*50	Communications
*51	Communications
*52	Communications
*53	Communications
*54	System-Wide
*56	Communications

Field	Group
*57	Communications
*58	Communications
*59	Communications
*77	Communications
*79	Communications
*80	Communications
*83	Communications
*84	Partition-Specific
*85	Partition-Specific
*87	Partition-Specific
*88	Partition-Specific
*89	Communications
*90	Partition-Specific
1*11	System-Wide
1*12	System-Wide
1*13	System-Wide
1*15	Communications
1*17	System-Wide
1*18	Partition-Specific
1*19	Partition-Specific
1*21	System-Wide
1*22	System-Wide
1*23	System-Wide
1*24	System-Wide
1*25	System-Wide
1*26	Partition-Specific
1*28	System-Wide
1*29	System-Wide
1*30	System-Wide
1*31	System-Wide
1*33	Communications
1*34	Communications
1*35	Communications
1*42	Communications
1*43	Partition-Specific
1*44	System-Wide
1*47	Partition-Specific
1*48	System-Wide
1*49	System-Wide
1*53	System-Wide
1*55	System-Wide
1*56	System-Wide
1*57	System-Wide
1*58	System-Wide
1*60	System-Wide
1*61	System-Wide
1*70	System-Wide
1*71	System-Wide
1*72	System-Wide

Field	Group
1*73	System-Wide
1*74	System-Wide
1*75	System-Wide
1*76	Partition-Specific
1*77	System-Wide
1*78	System-Wide
1*79	System-Wide
1*80	System-Wide
2*00	System-Wide
2*01	System-Wide
2*02	System-Wide
2*05	Partition-Specific
2*06	Partition-Specific
2*07	Partition-Specific
2*08	Partition-Specific
2*09	Partition-Specific
2*10	Partition-Specific
2*11	System-Wide
2*18	Partition-Specific
2*19	Partitioning
2*20	Partition-Specific
2*21	System-Wide
2*22	Partition-Specific
2*23	Partition-Specific
2*24	Partition-Specific
3*00	System-Wide
3*01	System-Wide
3*12	System-Wide
3*13	System-Wide
3*14	System-Wide
3*16	System-Wide
3*17	System-Wide
3*18	System-Wide
3*19	System-Wide
3*20	System-Wide
3*21	System-Wide
3*30	System-Wide
3*31	System-Wide
3*50	System-Wide
3*55	System-Wide
3*56	System-Wide
3*57	Partition-Specific
3*59	Partition-Specific
3*60	Partition-Specific
3*61	System-Wide
3*82	System-Wide
3*85	System-Wide

VISTA-128FBPN Programming Form

Some fields are programmed for each partition (shown as shaded fields). If you are programming a multiple-partition system, see the *Partition-Specific Fields* section for programming these fields. Standard default (*97) values are shown in brackets []; otherwise, default = 0.

***00** INSTALLER CODE

Enter 4 digits, 0-9 [5140]

***04** ENABLE RANDOM TIMERS

1 2 3 4 5 6 7 8

Enter 1 to make available the randomizing of pre-programmed time driven events for each partition. [0=disable].

Must be "0" for Commercial Burg installations.

***05** SYSTEM EVENTS NOTIFY [0]

1=yes, (messages sent via the RS232 port).

0=no, (no messages sent).

***06** QUICK EXIT [1]

1=enable; 0=disable

***08** TEMPORAL SIREN PULSE – **Not Used at this time.**

***09** ENTRY DELAY #1 [02]

00 (240 seconds), 02-15 times 15 seconds

Maximum "03" for Commercial Burglary installations.

The entry delay time and Abort Window (field *88) combined cannot exceed 60 seconds for SIA installations.

***10** EXIT DELAY #1 [04]

03-15 times 15 seconds

Maximum "04" for Commercial Burglary installations.

Minimum 60 seconds "04" for SIA installations.

***11** ENTRY DELAY #2 [02]

00 (240 seconds), 02-15 times 15 seconds (must be longer than Entry Delay #1). Maximum "03" for Commercial Burglary installations.

The entry delay time and Abort Window (field *88) combined cannot exceed 60 seconds for SIA installations.

***12** EXIT DELAY #2 [04]

03-15 times 15 seconds (must be longer than Exit Delay #1).

Maximum "04" for Commercial Burglary installations.

Minimum 60 seconds "04" for SIA installations.

***13** BELL 1 TIMEOUT [03]

01-15 times 2 minutes. Must be minimum 16 minutes for Commercial Burglary installations. Must be minimum 6 minutes for Commercial Fire and SIA installations.

***14** TRIGGER OR RS232 INPUT [0]

Enter 1 to set J2 Pin 5 as a RS232 input to enable system to receive serial data (75 baud).

Enter 0 to enable J2 Pin 5 as fire alarm trigger.

Must be set to "0".

***15** KEYSWITCH ASSIGNMENT [0]

Enter partition in which keyswitch used, 1-8; 9=silences

Notification Appliance Circuit if fire present; 0=disable

***16** BELL 1 CONFIRMATION OF ARMING DING [1]

1=enable; 0=disable.

NOTE: If using a keyfob, when the button is pressed, either for arming or disarming, the bell will ding indicating that the button is working.

Must be "1" for Commercial Burglary installations.

***17** AC LOSS KEYPAD SOUNDING [1]

1=enable; 0=disable

Must be "1" for Commercial Fire installations.

***19** RANDOMIZE AC LOSS REPORT [2]

0= within 2 minutes; 1=10-40 min; 2=1-3 hours; 3=6-12 hours without Type 13, 1-3 hours with Type 13.

***20** VIP MODULE PHONE CODE - **Not used.**

Enter 01 - 09 for the first digit; enter [00], [11]

11 for "*" or 12 for "#" for the second digit.

Must be set to "00" for Commercial Burglary and Commercial Fire installations.

***22** KEYPAD PANIC ENABLES [001]

1=enable; 0=disable

995 996 999

NOTE: Use for burglary panic types only. Do not use in partition 1 in Fire systems.

***24** IGNORE EXPANSION ZONE TAMPER [0]

1=Ignore; 0=Enable tamper for RF and V-Plexs.

Must be "0" for Commercial Burglary and Commercial Fire installations if using these devices.

***25** BURG.TRIGGER FOR RESPONSE TYPE 8 [1]

1=enable; 0=disable

***26** INTELLIGENT TEST REPORTING [0]

1=enable (no report sent if any other report was recently sent);

0=disable (send report at programmed interval, field *27)

Must be "0" for Commercial Burglary and Commercial Fire installations.

***27** TEST REPORT INTERVAL [0024]

Enter interval in hours, 0001-9999; 0000=no report; Max. 0024 for Commercial Burglary and Commercial Fire installations.

***28** POWER UP IN PREVIOUS STATE [1]

1=enable; 0=disable

Must be "1" for Commercial Burglary and Commercial Fire installations.

***29** QUICK ARM [1]

1=enable; 0=disable

***30** MAIN DIALER TOUCHTONE OR ROTARY [1]

1=TouchTone; 0=rotary

***31** PABX ACCESS CODE

00-09; B-F (11-15)

***32** PRIM. SUBS. ACCT #

Enter 00-09; B-F (11-15) [15 15 15 15]

***33 PRIMARY PHONE NUMBER**

Enter 0-9 for each digit. Enter #11 for *, #12 for #,
#13 for 2-second pause

***34 SECONDARY PHONE NUMBER**

Enter 0-9 for each digit. Enter #11 for *, #12 for #,
#13 for 2-second pause

***35 DOWNLOAD PHONE NO.**

Enter 0-9 for each digit. Enter #11 for *, #12 for #,
#13 for 2-second pause

***36 DOWNLOAD ID NO.**

--	--	--	--	--	--	--	--	--	--

Enter 00-09; A-F (10-15) [15 15 15 15 15 15 15]

***37 DOWNLOAD COMMAND ENABLES**

		0							
--	--	---	--	--	--	--	--	--	--

Dir ShtdwnSys ShtdwnNot UsedRmt BypRmt DisarmRmt ArmUpld PgmDwnld Pgm
See field 1*53 for Callback disable option; [1=enable];
0=disable. For Commercial Burglary and Commercial Fire
installations, all entries must be "0."

***38 PREVENT ZONE XXX BYPASS**

[000]		
-------	--	--

001-128; 000 if all zones can be bypassed

***39 ENABLE OPEN/CLOSE REPORT FOR**

[1]	
-----	--

INSTALLER CODE 1=enable; 0=disable

***40 OPEN/CLOSE REPORT FOR KEYSWITCH**

[0]	
-----	--

1=enable; 0=disable

***41 NORMALLY CLOSED or EOLR (Zones 3-8)**

[0]	
-----	--

1=N.C.loops; 0=EOLR supervision.

Must be "0" for Commercial Burglary and Commercial Fire
installations.

***42 DIAL TONE PAUSE**

[0]	
-----	--

0=5 seconds; 1=11 seconds; 2=30 seconds.

Must be "0" Commercial Burglary and Commercial Fire
installations.

***43 DIAL TONE DETECTION**

[1]	
-----	--

1=wait for true dial tone; 0=pause, then dial

***44 RING DETECTION COUNT**

[00]		
------	--	--

01-14; 15=answering machine; 00=no detection.

Must be "00" for Commercial Burglary and Commercial Fire
installations.

***45 PRIMARY FORMAT**

[1]	
-----	--

0=Low Speed; 1=Contact ID; 2=ADEMCO High Speed;
3= ADEMCO Express

***46 LOW SPEED FORMAT (Primary)**

[0]	
-----	--

0= ADEMCO Low Speed; 1=Sescoa/Radionics

***47 SECONDARY FORMAT**

[1]	
-----	--

0=Low Speed; 1=Contact ID; 2= ADEMCO High Speed;
3= ADEMCO Express

***48 LOW SPEED FORMAT (Sec.)**

[0]	
-----	--

0= ADEMCO Low Speed; 1=Sescoa/Radionics

***49 CHECKSUM VERIFICATION**

[0]	[0]		
-----	-----	--	--

1=enable; 0=disable

Prim Sec

***50 SESCOA/RADIONICS SELECT**

[0]	
-----	--

1=Sescoa; 0=Radionics

***51 DUAL REPORTING**

[0]	
-----	--

1=yes; 0=no If used with Split Reporting "1" option (1*34),
alarms and alarm restores go to both primary and secondary
numbers, while all other reports go to secondary only. If used
with Split Reporting "2" option, alarms and alarm restores go
to both, open/close and test messages go to secondary only,
while all other reports go to primary. If used with Split
Reporting "3" option, fire alarms and fire restores signals go to
both, all other reports go to secondary only.

***52 STANDARD/EXPANDED REPORT FOR PRIMARY**

[0]	[0]	[0]	[0]	[0]		
	Alarm	Rstr	Byp	Trbl	O/C	LoBat

0=standard; 1=expanded;

NOTE: Expanded overrides 4+2 format.

***53 STANDARD/EXPANDED REPORT FOR SECONDARY**

[0]	[0]	[0]	[0]	[0]		
	Alarm	Rstr	Byp	Trbl	O/C	LoBat

0=standard; 1=expanded;

NOTE: Expanded overrides 4+2 format.

***54 UNATTENDED MODE**

[1]	
-----	--

0=disable, 1=enable, if automatic downloads will be allowed
Must be "0" for Commercial Fire installations.

***56 DYNAMIC SIGNALING DELAY**

[03]		
------	--	--

Select the delay time (00-15) times 15 seconds before sending
to second destination.

NOTE: When Communicator is used as a backup to the dialer,
the Dynamic Signaling Delay (*56) should be set to a minimum
of 1 minute.

***57 DYNAMIC SIGNALING PRIORITY**

[0]	
-----	--

0=Primary dialer; 1=Communicator, as first reporting
destination.

NOTE: Must be set to "0" for SIA installations.

***58 COMM CENTRAL STATION #1 CATEGORY ENABLE**

[0]	[0]	[0]	[0]	[0]		
	Alarm	Trbl	Byp	O/C	Syst	Test

0=disable, 1=enable for reports for primary subs ID of
communicator.

***59 COMM CENTRAL STATION #2 CATEGORY ENABLE**

[0]	[0]	[0]	[0]	[0]		
	Alarm	Trbl	Byp	O/C	Syst	Test

0=disable, 1=enable for reports for secondary subs ID of
communicator.

***77** AUTO TROUBLE RESTORE [1] ☐

0=disable, 1=enable

***79** ZONE TYPE RESTORE ENABLES FOR ZONE TYPES

1-8 ☐ ☐ ☐ ☐ ☐ ☐ ☐ ☐
1 2 3 4 5 6 7 8

1=enable; [0=disable]

***80** FOR TYPES 9, 10 and 14 ☐ ☐ ☐

9 10 14

1=enable; [0=disable]

Restores must be set to "1" for Commercial Fire installations.

***83** FIRST TEST REPORT TIME

[Day 00; hour 12; min 00]. Days 01-07, Hours 00-23, Min 00-59; 00 in all boxes = instant (Day 01= Monday)

***84** SWINGER SUPPRESSION [01]

01= 1 alarm

02= 2 alarms

NOTE: Fire zones are exempt from this requirement.

Must be "00" (disabled) for Commercial Burglary installations.

***85** ENABLE DIALER REPORTS FOR PANICS & DURESS

1=enable; [0=disable] ☐ ☐ ☐ ☐
995 996 999 Duress

***87** ENTRY WARNING [1] ☐

1=continuous; 0=3 beeps

***88** ABORT WINDOW [2] ☐

1=15 seconds; 2=30 seconds; 3=45 seconds

Must be "0" for Commercial Burglary installations.

Must be "2" for SIA installations.

***89** ALARM RESTORE REPORT TIMING [0] ☐

0 = Restore is sent when zone is restored or at disarming, whichever occurs first.

1 = Restore is sent at disarming whether zone is restored or not, or at bell timeout, but only if restored.

2 = Restore is sent at disarming, whether the zone is restored or not.

This field applies only to Burglary zone types. It does not apply to Fire or Panic zone types.

Must be "2" for Commercial Burglary installations.

***90** SEC. SUBS. ACCT #

Enter 00-09; B-F (11-15) [15 15 15 15]

1*11 ZONE BYPASS AFTER DISARM

[00000000] ☐ ☐ ☐ ☐ ☐ ☐ ☐ ☐
1 2 3 4 5 6 7 8

1=enable; 0=disable

Enter 1 for each partition in which zones will remain bypassed after disarm.

NOTES:

For each partition in which field 1*11 is enabled, the **USER CODE + OFF** will no longer unbypass zones. To unbypass ALL zones, you must enter **USER CODE + # + 64**. To unbypass zones INDIVIDUALLY, you must enter **USER CODE + 6 + zone number**.

Any zone that was automatically bypassed by the system will be unbypassed upon disarming of the system (e.g., STAY mode, Auto-STAY, etc.).

Vent zones and zones bypassed by a programmed Auto-Bypass schedule (Timed Driven Event) are considered

"manual bypasses" and will not be unbypassed upon disarming the system.

Zones that were in a bypassed state at the time a System Shutdown is sent from the Compass Downloading software will be unbypassed when the System Shutdown is removed.

1*12 PROGRAM NOTIFICATION SIGNAL [1] ☐

1=yes; 0=no

Must be "1" for Commercial Fire installations.

1*13 SYSTEM SENSOR REVERSING RELAY – Not Used.

[0] ☐

0=use neither Zone 1 or Zone 2 inputs; 1=use Zone 1 input; 2=use Zone 2 input; 3=use Zone 1 and Zone 2 inputs.

1*15 CANCEL VERIFY [1] ☐

0=disable, 1=enable alarm output pulse upon kissoff of

Cancel report. **NOTE:** Field 1*52 must be enabled to send a Cancel report to the central station.

NOTE: Cancel reports must be enabled in system group 1.

1*17 LOBBY PARTITION [0] ☐

Enter the "common lobby" partition (1-8)

1*18 AFFECTS LOBBY [0] ☐

Enter 1 if this partition affects the common lobby;

Enter 0 if it does not.

Must be "0" for Commercial Burglary and Commercial Fire installations.

1*19 ARMS LOBBY [0] ☐

Enter 1 if arming this partition attempts to arm lobby;

Enter 0 if it does not.

Must be "0" for Commercial Burglary and Commercial Fire installations.

1*21 EXIT DELAY RESET [1] ☐

0=No; 1=Resets Exit Delay to programmed value after zone is closed and then faulted prior to end of exit delay.

Must be "0" for Commercial Burglary installations. Exit Delay must be enabled "1" for SIA installations.

FIELDS 1*22-1*25: Allow four sets of two zones each to be linked so that both must fault within a 5-minute period to cause an alarm. Default for these fields = [000], [000].

1*22 CROSS-ZONING PAIR ONE

1*23 CROSS-ZONING PAIR TWO

1*24 CROSS-ZONING PAIR THREE

1*25 CROSS-ZONING PAIR FOUR

1*26 PANIC BUTTON OR SPEEDKEY

[00, 00, 00, 00]
A B C D

Enter speedkey macro # (01-32) to use keys A-C for macro. Otherwise enter 00 to use as panic. For D key, enter macro # 01-32, or 00 to select macro when key is pressed.

1*28 RF TX LOW BATTERY SOUND [0] ☐

1=immediate; 0=when disarmed

Must be 1 for UL installations.

1*29 RF TX LOW BATTERY REPORTING [0] ☐

1=enable; 0=disable

Must be 1 for UL installations.

1*30 RF RCVR CHECK-IN INTERVAL [02]

02-15 times 2 hours; 00 disables supervision
Maximum is 2 (4 hr) for UL installations.

1*31 RF XMITTER CHECK-IN INTERVAL [02]

02-15 times 2 hours; 00 disables transmitter supervision
Maximum is 2 (4 hr) for UL installations.

1*33 TOUCHTONE W/ROTARY BACKUP [0]

1=enable; 0=disable

1*34 COMM. SPLIT REPORTING [0]

0=no; 1=alarms and alarm restores primary, others secondary; 2=open/close, test secondary, others primary; 3=fire alarms and fire restores to primary and secondary, all others to secondary. See T51 for comments if using with dual reporting.

NOTE: Split reporting should not be used with Dynamic Signaling.

1*35 ACCESS CONTROL DIALER ENABLES - **Not Used.**

[0 0 0 0 0 0]

Trace Trbl Byp Not Used Syst Alm

1=enable; 0=disable

Must Be Set To "0".

1*42 CALL WAITING DEFEAT [0]

1=enable; 0=disable

1*43 PERM. KEYPAD BACKLIGHT [0]

1=enable; 0=disable, when disabled, display lights when any key is pressed, and turns off after period of keypad inactivity.

1*44 WIRELESS KEYPAD TAMPER DETECTION - **Not Used. Must be set to "0".**

[0]

1=enable; 0=disable.

1*47 CHIME ON BELL 1 [0]

1=enable; 0=disable

1*48 WIRELESS KEYPAD ASSIGNMENT - **Not Used. Must be set to "0".**

[0]

0=disable; enter partition in which RF keypad used, 1-8.

1*49 SUPPRESS TX SUPERVISION SOUND [1]

1=disable; 0=enable.

Must be "0" for Commercial Burglary and Fire installs.

1*53 DOWNLOAD CALLBACK [0]

1=callback not required; 0=callback required.

Must be "0" for Commercial Burglary and Commercial Fire installations.

1*55 EUROPEAN DATE FORMAT [0]

0=disable (mm/dd/yy); 1=enable (dd/mm/yy).

1*56 AC 50/60 Hz CLOCK SPEED [0]

1=50 Hz; 0=60 Hz.

1*57 5800 RF BUTTON GLOBAL ARM [0]

1=enable; 0=disable

Must be "0" for Commercial Burglary and Commercial Fire installations.

1*58 5800 RF BUTTON FORCE ARM [0]

1=enable. If a zone is faulted after pressing button, console will beep once. User should press button again within 4 sec. to force bypass those zones. 0=disable.
Must be "0" for Commercial Burglary and Commercial Fire installations.

1*60 ZONE 5 AUDIO ALARM VERIFICATION [0]

Enter 1 if 2-way audio (AAV) is being used; Enter 0 if it is not. Must be "0" for Commercial Burglary and Commercial Fire installations.

1*61 ABORT VERIFY [1]

0=disable; 1=enable

Must be enabled "1" for SIA installations.

1*70 EVENT LOG TYPES

[1 0 0 0 1 0]

Alarm Chk Byp O/C Syst Test

1=enable; 0=disable

1*71 12/24 HOUR TIME STAMP FORMAT [0]

0=12 hour; 1=24 hour

1*72 EVENT LOG PRINTER ON-LINE - **Not Used. Must Be Set To "0".**

[0]

0=disable; 1=enable

1*73 PRINTER BAUD RATE - **Not Used. Must Be Set To "0"..**

[0]

1=300; 0=1200

1*74 RELAY TIMEOUT XXX MINUTES [000]

Enter relay timeout, **0-127** in multiples of 2 minutes, desired for #80 Menu Mode time-driven event relay command numbers "04/09" and #93 Menu Mode Output Programming output command "56."

1*75 RELAY TIMEOUT YYY SECONDS [000]

Enter relay timeout, **0-127** seconds, desired for #80 Menu Mode time driven event relay command numbers "05/10" and #93 Menu Mode Output Programming command "57."

1*76 CONTROL RELAY [00]

Relay will be pulsed for 2 seconds whenever code + [0] is pressed. Enter relay number 01-96; 00=none.
Must be "00" for Commercial Burglary and Commercial Fire installations.

1*77 LOG FIRST MAINTENANCE SIGNAL [0]

0=No Log; 1=Log first maintenance signal from each smoke detector.

1*78 EXTENDED HOME CONT EVENTS [0]

Not Used. Must Be Set To "0".

0=Limited home control command set (32 commands).

1=Extended home control command set (255 commands).

1*79 HOME CONTROL EVENTS

[0 0 0 0 0 0] ☐ ☐ ☐ ☐ ☐ ☐
Alarm Trbl Byp O/C Syst Test

Not Used. Must Be Set To "0" In Each Entry.

1=enable; 0=disable. Select the type of events (status reports) transmitted via the RS232 output.

1*80 LOG FAULTS AND RESTORES [1] ☐

0=Disabled
1=Enabled

3rd Page Programming Fields (press *94)

2*00 NUMBER OF PARTITIONS [1] ☐

Enter 1-8

2*01 DAYLIGHT SAVING TIME [03, 11] ☐ ☐

START/END MONTH Start End

00-12; if no daylight saving time, enter 00,00

2*02 DAYLIGHT SAVING TIME [2, 1] ☐ ☐

START/END WEEKEND Start End

Enter 1-7. 1=first; 2=second; 3=third; 4=fourth; 5=last; 6=next to last; 7=3rd from last [1,5]

2*05 AUTO-ARM DELAY [15] ☐ ☐

Enter the time between the end of the arming window and the start of auto-arming warning period, in values of 1-14 times 4 minutes 00=instant; [15=no auto arm at all]. When this delay expires, the Auto-Arm Warning Period begins.

2*06 AUTO-ARM WARNING PERIOD [15] ☐ ☐

This is the time during which the user is warned to exit the premises prior to the auto-arming of the system (beeps every 15 seconds; "ALERT" displayed). Enter 01-15 minutes. 00=instant at end of arming delay.

2*07 AUTO-DISARM DELAY [15] ☐ ☐

This is the time between the end of the disarming window and the start of auto-disarming. Enter 01-14 times 4 minutes; 00=instant at end of window; 15=no auto-disarm.

2*08 ENABLE FORCE ARM FOR AUTO-ARM [0] ☐

0=disable; 1=enable

2*09 OPEN/CLOSE REPORTS BY EXCEPTION [0] ☐

1=enable; 0=disable

If enabled, only openings and closings occurring outside the scheduled opening/closing windows will trigger dialer reports. Opening reports will also be suppressed during the closing window, in order to prevent false reports when the user arms the system and then reenters the premises to retrieve a forgotten item.

2*10 ALLOW DISARMING ONLY DURING [0] ☐

ARMING/DISARMING WINDOWS

0=disable; 1=enable

See system-wide field 2*11 if enabling field 2*10. This feature adds high security to the installation.

2*11 ALLOW DISARM OUTSIDE WINDOW [0] ☐

IF ALARM OCCURS

Used only if field 2*10 is set to "1." If this field is enabled ("1") the system can be disarmed outside the disarm window if an alarm has occurred. If "0," disarming can only be done during the disarm window. If field 2*10 is set to "0" for a partition, this field has no effect for that partition.

2*18 ENABLE GOTO FOR THIS PARTITION [0] ☐

1=Allow log-on from other partitions; 0=disable

NOTE: Must be disabled for partition 1 in Commercial Fire installations.

2*19 USE PARTITION DESCRIPTORS [0] ☐

0=disable; 1=enable

2*20 ENABLE J2 TRIGGERS FOR PARTITION [1] ☐

0=disable; 1=enable for displayed partition

2*21 ENABLE SUPERVISION PULSES FOR LRR - Not Used. Must Be Set To "00000".

00000] ☐ ☐ ☐ ☐ ☐
F B P S T

Used only for supervised connection to non-ECP supported LRR.

Enter 0 to disable or 1 to enable the listed outputs.

F= Fire; B= Burglary/Audible Panic; P= Silent Panic/Duress; S= Supervisory; T= Trouble.

2*22 DISPLAY FIRE ALARMS OF [0] ☐

OTHER PARTITIONS

0=disable; 1=enable.

Must be set to "0" (disable) for partition 1.

2*23 DISPLAY BURG, PANIC and CO [0] ☐

ALARMS OF OTHER PARTITIONS

0=disable; 1=enable.

Must be set to "0" (disable) for partition 1.

2*24 DISPLAY TROUBLES OF OTHER [0] ☐

PARTITIONS

0=disable; 1=enable

Must be set to "0" (disable) for partition 1.

4th Page Programming Fields (press *94)

3*00 DISPLAY TRBL INSTEAD OF CHECK [0] ☐

0=CHECK; 1=TRBL

3*01 EVENTS DISPLAY LOCK [1] ☐

0=scroll all alarms; 1=lock display of first fire alarm

NOTE: Must be set to "1" for Commercial Fire Installations.

3*12 ZN TYPE 18 DELAY USE [1] ☐

0=disable; 1=enable

NOTE: Must be set to "0" for Commercial Fire Installations.

3*13 FIRE SUPERVISORY RESPONSE TO OPEN/SHORT

(Applies to Zone Type 18)

[0] ☐

0=Trouble on open/Supervisory on short

1=Supervisory on open/Supervisory on short

NOTE: Must be set to "0" for Commercial Fire Installations.

3*14 WATERFLOW SILENCE OPTION [0] ☐

0=silence on code = off; 1=silence when waterflow restores

NOTE: Must be set to "0" for Commercial Fire Installations.

3*16 DELAY FOR ZONE TYPE 17 & 18 [00] ☐ ☐

Enter 00-15 times 2 seconds

Delay cannot exceed 90 seconds in UL installations.

NOTE: Must be "00" for Commercial Fire installations.

3*17 ALTERNATE FUNCTION (TAMPER) [0] ☐

FOR ZONE 6 0=disable; 1=enable

3*18 EXTENDED DELAY FOR TYPES 17 & 18 [0] ☐

0=disable; 1=enable

NOTE: Must be "0" for Commercial Fire installations.

3*19 AUX INPUT ALTERNATE FUNC ENABLE [0] ☐

0=pins 5 and 9 function as per filed 3*20;

1=pins 5 and 9 function as RXD and DTR

NOTE: Must be set to "0" for Commercial Fire Installations.

3*20 TRIGGER OUTPUT SELECTION [0] ☐

0=Communicator full connection & remote console sounder;

1=Communicator limited connection and keyswitch LEDs

2=Communicator fire only connection and 5140LED

NOTE: Must be set to "0" for Commercial Fire Installations.

3*21 MAX NUMBER OF DIALER ATTEMPTS [8] ☐

1-8 (3, 4 or 5 for NFPA72 compliant systems when a secondary phone number is programmed (field *34))

3*30 DIALER SELECTION [1,0] ☐ ☐

0=disable; 1=enable

Main Backup

NOTE: If 3*30 is disabled (0, 0), the panel does not report at all via Communicator.

3*31 BACKUP DIALER TOUCHTONE/ROTARY [0] ☐

1=TouchTone; 0=Rotary

3*50 ZONE TYPE RESTORE ENABLES ☐ ☐ ☐

FOR ZONE TYPES 16-18

1=enable; [0=disable]

Restores must be set to "1" for Commercial Fire installs.

3*55 RESET ON SECOND OFF FOR BELL 1 [0] ☐

0=disable; 1=enable

NOTE: Must be set to "0" for Commercial Fire Installations.

3*56 RESET ON SECOND OFF FOR BELL 2 [0] ☐

0=disable; 1=enable

NOTE: Must be set to "0" for Commercial Fire Installations.

3*57 BELL 2 & AUX RELAY CONFIRM [0,0] ☐ ☐

ARMING DING

Bell 2 Aux

0=disable; 1=enable.

NOTE: If using a keyfob, when the button is pressed, either for arming or disarming, the bell will ding indicating that the button is working.

Must be "1" for Commercial Burglary installations.

3*59 ENABLE BELL 2 & AUX RELAY [0,0] ☐ ☐

CHIME ANNUNCIATION

Bell 2 Aux

0=disable; 1=enable

NOTE: Must be "0, 0" if Bell 2 or Aux. Relay is used for fire application.

3*60 BELL 2 & AUX RELAY TIMEOUT ☐ ☐

Bell 2

Aux

Enter 00-15 times 2 minutes; 00=no timeout [00,00]

Minimum 16 minutes for Commercial Burglary installations.

3*61 AUX RELAY FUNCTION [1] ☐

0=trouble/supervisory; 1=alarm, silenced by code = off;

2=smoke detector reset; 3=battery save; 4=alarm, silenced

by code = # = 67

NOTE: See Data Field Descriptions in the Installation and Setup Guide for specific information.

3*82 ENABLE BURG FEATURES ON PART 1 [1] ☐

0=disable (disables AWAY, STAY, MAX, TEST, INSTANT and CHIME); 1=enable;

NOTE: Must be "0" for Commercial Fire installations.

3*85 ENABLE FIRE & SYSTEM ZONE BYPASS [1] ☐

0=disable; 1=only installer can bypass;

2=only installer and master can bypass.

Applies to fire zone types 9, 16, 17, and 18 and system zones 970-977 and to partition 1 only.

Partition-Specific Fields

(Duplicate this page for each partition in the installation.)

To program these fields,

1. Press *91 to select a partition.
2. Enter a partition-specific field number (ex. *09).
3. Make the required entry.
4. Repeat steps 1-3 for each partition in the system.

PARTITION # ____ PROGRAM FIELDS

1st Page Fields

- *06** QUICK EXIT [1]
1=enable; 0=disable
- *09** ENTRY DELAY #1 [02]
00 (240 seconds), 02-15 times 15 seconds
Maximum "03" for Commercial Burglary installations.
The entry delay time and Abort Window (field *88) combined cannot exceed 60 seconds for SIA installations.
- *10** EXIT DELAY #1 [04]
03-15 times 15 seconds
Maximum "04" for Commercial Burglary installations.
Minimum 60 seconds "04" for SIA installations.
- *11** ENTRY DELAY #2 [02]
00 (240 seconds), 02-15 times 15 seconds (must be longer than Entry Delay #1). Maximum "03" for Commercial Burglary installations.
The entry delay time and Abort Window (field *88) combined cannot exceed 60 seconds for SIA installations.
- *12** EXIT DELAY #2 [04]
03-15 times 15 seconds
Maximum "04" for Commercial Burglary installations.
Minimum 60 seconds "04" for SIA installations.
- *13** BELL 1 TIMEOUT [03]
01-15 times 2 minutes. Must be set to a minimum 16 minutes for Commercial Burglary installations. Must be minimum 6 minutes for Commercial Fire and SIA installations.
- *16** BELL 1 CONFIRMATION OF ARMING DING [0]
1=enable; 0=disable.
NOTE: If using a keyfob, when the button is pressed, either for arming or disarming, the bell will ding indicating that the button is working.
Must be "1" for Commercial Burglary installations.
- *22** KEYPAD PANIC ENABLES [001]
1=enable; 0=disable 995 996 999
NOTE: Use for burglary panic types only. Do not use in partition 1 in Fire systems.
- *29** QUICK ARM [1]
1=enable; 0=disable
- *32** PRIM. SUBS. ACCT #
Enter 00-09; B-F (11-15) [15 15 15 15]
- *38** PREVENT ZONE XXX BYPASS [000]
001-128; 000 if all zones can be bypassed

- *39** ENABLE OPEN/CLOSE REPORT [1]
FOR INSTALLER CODE
1=enable; 0=disable
- *84** SWINGER SUPPRESSION [01]
01= 1 alarm
02= 2 alarms
NOTE: Fire zones are exempt from this requirement.
Must be "00" (disabled) for Commercial Burglary installations.
- *85** ENABLE DIALER REPORTS FOR PANICS & DURESS

1=enable; [0=disable] 995 996 999 Duress
- *87** ENTRY WARNING [1]
1=continuous; 0=3 beeps
- *88** ABORT WINDOW [2]
1=15 seconds; 2=30 seconds; 3=45 seconds
Must be "0" for Commercial Burglary installations.
Must be "2" for SIA installations.
- *90** SEC. SUBS. ACCT #
Enter 00-09; B-F (11-15) [15 15 15 15]

2nd Page Fields

- 1*18** AFFECTS LOBBY [0]
Enter 1 if this partition affects the common lobby; enter 0 if it does not.
Must be set to "0" for Commercial Burglary and Commercial Fire installations.
- 1*19** ARMS LOBBY [0]
Enter 1 if arming this partition attempts to arm lobby; enter 0 if it does not
Must be "0" for Commercial Burglary and Commercial Fire installations.
- 1*26** PANIC BUTTON OR SPEEDKEY

[00, 00, 00, 00] A B C D
Enter speedkey macro # (01-32) to use keys A-C for macro. Otherwise enter 00 to use as panic. For D key, enter macro # 01-32 or 00 to select macro when key is pressed.
- 1*43** PERM. KEYPAD BACKLIGHT [0]
1=enable; 0=disable
When disabled, display lights when any key is pressed, and turns off after period of keypad inactivity.

1*47 CHIME ON BELL 1 [0] ☐

1=enable; 0=disable

1*76 CONTROL RELAY FOR PART. [00] ☐

Relay will be pulsed for 2 seconds whenever code + [0] is pressed. Enter 00-96; 00=none.
Must be "00" for Commercial Burglary and Commercial Fire installations.

3rd Page Fields

2*05 AUTO-ARM DELAY [15] ☐

Enter the time between the end of the arming window and the start of auto-arming warning period, in values of 1-14 times 4 minutes 00=instant; [15=no auto arm at all]. When this delay expires, the Auto-Arm Warning Period begins.

2*06 AUTO-ARM WARNING PERIOD [15] ☐

This is the time during which the user is warned to exit the premises prior to the auto-arming of the system (beeps every 15 seconds; "ALERT" displayed). Enter 01-15 minutes. 00=instant at end of arming delay.

2*07 AUTO-DISARM DELAY [15] ☐

This is the time between the end of the disarming window and the start of auto-disarming. Enter 01-14 times 4 minutes; 00=instant at end of window; 15=no auto-disarm

2*08 ENABLE FORCE ARM FOR AUTO-ARM [0] ☐

0=disable; 1=enable

2*09 OPEN/CLOSE REPORTS BY EXCEPTION [0] ☐

1=enable; 0=disable. If enabled only openings and closings occurring outside the scheduled opening/closing windows trigger dialer reports. Opening reports will also be suppressed during the closing window, in order to prevent false reports when the user arms the system and then re-enters the premises to retrieve a forgotten item.

2*10 ALLOW DISARMING ONLY DURING [0] ☐

ARMING/DISARMING WINDOWS

See system-wide field 2*11 if enabling field 2*10. This feature adds high security to the installation.
0=disable; 1=enable

2*18 ENABLE GOTO FOR THIS PARTITION [0] ☐

1=Allow log-on from other partitions; 0=disable

NOTE: Must be disabled (0) for partition 1 in Commercial Fire installations.

2*20 ENABLE J2 TRIGGERS BY PARTITION [1] ☐

0=disable for displayed partition; 1=enable for displayed partition

2*22 DISPLAY FIRE ALARMS OF [0] ☐

OTHER PARTITIONS

0=disable; 1=enable

Must be set to "0" (disable) for partition 1.

2*23 DISPLAY BURG, PANIC AND CO ALARMS [0] ☐

OF OTHER PARTITIONS

0=disable; 1=enable

Must be set to "0" (disable) for partition 1.

2*24 DISPLAY TROUBLES OF OTHER [0] ☐

PARTITIONS

0=disable; 1=enable

Must be set to "0" (disable) for partition 1.

4th Page Fields

3*57 BELL 2 & AUX RELAY CONFIRM [0,0] ☐ ☐

ARMING DING

0=disable; 1=enable.

NOTE: If using a keyfob, when the button is pressed, either for arming or disarming, the bell will ding indicating that the button is working.

Must be set to "1" for Commercial Burglary installations.

3*59 ENABLE BELL 2 & AUX RELAY [0, 0] ☐ ☐

CHIME ANNUNCIATION

0=disable; 1=enable

NOTE: Must be "0, 0" if Bell 2 or Aux. Relay is used for fire application.

3*60 BELL 2 & AUX RELAY TIMEOUT ☐ ☐

Bell 2 Aux

Enter 00-15 times 2 minutes; 00=no timeout [00, 00]

Minimum 16 minutes for Commercial Burglary installations.

SUMMARY OF PROGRAMMING COMMANDS

- **To enter program mode**, enter installer code + [8] + [0] + [0] + [0]
- **To set standard defaults**, press *97
- **To change to next page of program fields**, press *94
- **To return to previous set of fields**, press *99
- **To erase account and phone number field entries**, press [*] + field number + [*]
- **To assign zone descriptors**, press #93 + follow menu prompts
- **To add custom words**, press #93 + follow menu prompts
- **To enter Installer's Message**, press #93 + follow menu prompts
- **To exit program mode**, enter *99 OR *98: *99 allows re-access to programming mode by installer code. *98 prevents re-access to programming mode by installer code.

Programming With #93 Menu Mode

NOTE: The following field should be preset before beginning: 2*00 Number of Partitions. In addition, receivers should be programmed via Device programming.

After programming all system related programming fields in the usual way, press #93 while still in programming mode to display the first choice of the menu driven programming functions. Press 0 (NO) or 1 (YES) in response to the displayed menu selection. Pressing 0 will display the next choice in sequence.

#93 MENU MODE KEY COMMANDS

The following is a list of commands used while in the menu mode.

#93	Enters Menu mode
[Q]	Serves as ENTER key. Press to have keypad accept entry.
[#]	Backs up to previous screen.
0	Press to answer NO
1	Press to answer YES
001-009	All data entries are either 2-digit or 3-digit entries.
000	Exits menu mode, back into field programming mode, when entered at the first question for each category.

Menu selections are as follows:

PROMPT	EXPLANATION
<div>ZONE PROG? 1 = YES 0 = NO 0</div>	For programming the following: <ul style="list-style-type: none">• Zone Number• Zone Response Type• Partition Number for Zone• Dialer report code for zone• Input Device Type for zone (whether RF, polling loop, etc.)• Enrolling serial numbers of 5800 Series transmitters & serial polling loop devices into the system.• Zone Attributes (e.g., Arm w/Fault, Silent, etc.)
<div>EXPERT MODE? 1 = YES 0 = NO 0</div>	Same as Zone Programming except: <ul style="list-style-type: none">• Done with a minimum number of keystrokes.• Can program wireless keys using pre-defined templates. NOTE: Be aware some of the zone attributes cannot be programmed in the Expert Mode. These can only be done in Zone Programming.
<div>REPORT CODE PROG? 1 = YES 0 = NO 0</div>	For programming the following: <ul style="list-style-type: none">• Alarm report codes for zones• Restore & supervisory codes• All other system report codes
<div>ALPHA PROG? 1 = YES 0 = NO 0</div>	For entering alpha descriptors for the following: <ul style="list-style-type: none">• Zone Descriptors• Default Screen• Custom Words• Partition Descriptors
<div>DEVICE PROG? 1 = YES 0 = NO 0</div>	For defining the following device characteristics for addressable devices, including keypads, RF receivers (5881ENHC), output relay modules (4204/4204CF), and Communicators (7845i-ent, 7845i-GSM, 7845GSM). <ul style="list-style-type: none">• Device Address• Device Type• Keypad Options (incl. partition assignment)• RF House ID• Communicator Options (incl. programming communicators)
<div>OUTPUT PGM? 1 = YES 0 = NO 0</div>	For defining output relay functions.
<div>RLY VOICE DESCR? 1 = YES 0 = NO 0</div>	Not Used. Must be set to "0".

PROMPT	EXPLANATION
CUSTOM INDEX? 1 = YES 0 = NO 0	Not Used. Must be set to "0".
ACCESS POINT PGM 1 = YES 0 = NO 0	Not Used. Must be set to "0".
ACCESS GRP PGM 1 = YES 0 = NO 0	Not Used. Must be set to "0".
EVENT/ACTION PGM 1 = YES 0 = NO 0	Not Used. Must be set to "0".
SCHEDULED CHK-IN 1 = YES 0 = NO 0	For defining the schedule for the system to automatically call the downloader. NOTE: Must be set to "0" for Commercial Fire installations.

Zone Programming



- All Fire zones should be assigned to partition 1.
- If using 5800 Series transmitters, do not install batteries until you are ready to enroll them. After enrolling the transmitter, the battery need not be removed. This is to prevent enrolling the wrong serial number.

PROMPT	EXPLANATION
ZONE PROG? 1 = YES 0 = NO 0	Press 1 to enter ZONE PROGRAMMING mode. The following screens appear. Press [*] to display the next screen. Press # to display a previous screen.
SET TO CONFIRM? 1 = YES 0 = NO 0	This prompt appears once upon entering Zone Programming Mode. If "Yes," Confirmation prompts will be displayed after the device's Serial and Loop numbers have been entered later.
ENTER ZONE NO. 000 = QUIT 010 Zone 010 entered ↑	Enter the 3-digit zone number to be programmed, as follows: Protection Zones = 001–128 Relay Zones = 601–632 (use for relays on 4204CF modules only). ECP Device Supervisory Zones = 800–830 System Supervisory Zones = 988, 990, 992 (duress), 997 Keypad Panic Zones = 995 (Do not use in Fire Alarm applications), 996, 999 Press [*] to continue.
010 ZT P RC In L 00 1 10 00 1	This display appears, showing a summary of the zone's current programming. ZT = Zone Type, P = Partition, RC = Report Code, In = the input type of device, and L = the device's loop number to which the sensor is connected. Some devices can support more than one zone by means of individual loops (for example 5817CB, etc.). If the zone is not programmed, the display appears as shown here. If you are checking a zone's programming, and it is programmed satisfactorily, press [#] to back up one step and enter another zone number, if desired. Press [*] to continue.

PROMPT	EXPLANATION
010 ZONE TYPE PERIMETER 03 Zone number 010 and Zone Type 03 entry shown † These are special zone types used with 5800 Series Wireless Pushbutton Units that result in arming the system in the STAY or AWAY mode, or disarming the system, depending on the selection made.	Each zone must be assigned a zone type, which defines the way in which the system responds to faults in that zone. Refer to the <i>Zone Type Definitions</i> section in the <i>VISTA-128FBPN Installation and Setup Guide</i> for detailed definitions of each zone type. Enter the zone type desired (or change it, if necessary). Available zone types are listed below. 00 = Assign for Unused Zones 01 = Entry/Exit #1, Burglary 02 = Entry/Exit #2, Burglary 03 = Perimeter, Burglary 04 = Interior Follower, Burglary 05 = Trouble Day/Alarm Night 06 = 24 Hr. Silent Alarm 07 = 24 Hr. Audible Alarm 08 = 24 Hr. Auxiliary (Not for Medical Use) 09 = Fire Without Verification 10 = Interior Delay, Burglary 12 = Panel Link Supervision – Not Used 13 = Remote P/S 14 = CO Detector Alarm 16 = Fire With Verification 17 = Waterflow 18 = Fire Supervisory 19 = 24-Hour Trouble 20 = Arm–STAY† 21 = Arm AWAY† 22 = Disarm† 23 = No Alarm Response (e.g., relay activation) 27 = Access Point – Not Used 28 = MLB Supervision (if VGM installed) – Not Used 29 = Momentary Exit (used with VistaKey module) - Not Used Press [*] to continue.
010 Arm w/ Fault? 1 = YES 0 = NO 0	If you selected response type 1, 2, 4, or 10 , this prompt appears. Enter 1 to enable arming of the partition with this zone faulted. The zone must be restored (see Force Arming, the next prompt) before the exit delay expires otherwise the system starts the entry delay and must be disarmed, or an alarm occurs.
010 Force Arming? 1 = YES 0 = NO 0	If you entered 1 (YES) at the previous prompt , this prompt appears. Enter 1 to enable the system to automatically bypass the zone if it is faulted at the end of the exit delay. If you enter 0 to disable and the zone is faulted at the end of exit delay, the system either performs the exit error logic or an alarm occurs. NOTE: Force Arming cannot be enabled for UL installations.
010 Vent zone ? 1 = YES 0 = NO 0	If you selected response type 3 , this prompt appears. Enter 1 to enable the arming of the partition with this zone faulted (force arm). The zone is automatically bypassed. NOTE: The zone may be unbypassed simply by restoring the zone (e. g., closing the window), if the Vent Re-arm option (next prompt) for the zone is enabled. Enter 0 to disable. Press [*] to continue.
010 Vent Re-arm ? 1 = YES 0 = NO 1	If you entered 1 (YES) at the previous prompt , this prompt will appear. Enter 1 to enable the system to automatically unbypass the zone when it is restored (e.g., by closing the window). Enter 0 to disable. The zone is bypassed for the duration of the armed period regardless of the zone status. Press [*] to continue.
010 STAY MODE None 0	If you selected response type 1, 2, 3, 4, 5, or 10 , this prompt will appear. Enter the STAY mode for this zone (0-2). 0 = None. The zone is not bypassed when the partition is armed STAY. 1 = Stay 1. The zone is automatically bypassed when the user enters [User Code] + [3] (STAY) + [1]. 2 = Stay 2. The zone is automatically bypassed when the user enters [User Code] + [3] (STAY) + [2]. NOTES: 0 (None) cannot be selected for response types 4 and 10. Response types 4 and 10 are defaulted for STAY mode 1. If the user enters [User Code] + [3] (STAY) + [3], all zones assigned to Stay mode 1 and 2 in the partition are automatically bypassed. If none of the zones in the partition are assigned to Stay mode 2, then when the user enters [User Code] + [3] (STAY), all zones assigned to Stay mode 1 are automatically bypassed. Press [*] to continue.
010 Auto-stay ? 1 = YES 0 = NO 0	If you selected response type 1, 2, 3, 4, 5, or 10 , this prompt will appear. Enter 1 to enable. The zone is automatically bypassed if none of the entry/exit zones are opened during the exit delay time (no one exits the premises). Enter 0 to disable. NOTES: All zones enabled for auto-stay except types 3 and 5 have exit delay time when the partition is armed. If auto-stay is enabled, make sure at least one zone is programmed for entry/exit in the same partition, otherwise this zone will be automatically bypassed every time the partition is armed. Press [*] to continue.

PROMPT	EXPLANATION
<div>010 Silent ?</div> <div>1 = YES 0 = NO 1</div>	<p>If you selected response type 1, 2, 3, 4, 5, or 10, this prompt will appear. Enter 1 to enable. The zone follows all the selected response type's characteristics, except in the alarm condition, the alarm output and the keypad sounder do not sound and the keypad does not display the alarm condition.</p> <p>Enter 0 to disable.</p> <p>Press [*] to continue.</p>
<div>010 Bypass Group</div> <div>01-15 01</div>	<p>If you selected response type 1, 2, 3, 4, 5, or 10, this prompt will appear. Enter the bypass group for the zone (01–15). This enables the user to bypass a group of zones by entering [User Code] + [6] (Bypass) + [*] + [Group No.] (01-15).</p> <p>Enter 00 for None.</p> <p>Press [*] to continue.</p>
<div>010 Partition</div> <div>1</div>	<p>Enter the partition number (1–8) you are assigning this zone to.</p> <p>Press [*] to continue.</p>
<div>010 Abort Window</div> <div>1 = YES 0 = NO 1</div>	<p>0 = No abort window.</p> <p>1 = Yes, use abort window according to field *88 selection.</p>
<div>010 Swinger Sup?</div> <div>1 = YES 0 = NO 1</div>	<p>0 = No suppression.</p> <p>1 = Yes, suppress alarms according to field *84 selection.</p>
<div>010 REPORT CODE</div> <div>1st 03 2nd 12 3C</div>	<p>Enter the report code. The report code consists of 2 hexadecimal digits, each in turn consisting of 2 numerical digits. For example, for a report code of "3C," enter 03 for "3" and 12 for "C."</p> <p>(Refer to the <i>System Communication</i> section in the <i>Installation and Setup Guide</i> for more information about report codes and reporting formats.)</p> <p>Press [*] to continue.</p>
<div>010 BELL/RLY SEL</div> <div>0</div>	<p>Each zone can be assigned to activate either one or both Notification Appliance Circuits and/or the system's auxiliary relay. Enter one of the following assignments:</p> <p>0=none; 1=bell 1; 2=bell 2; 3=bell 1 & bell 2; 4=aux relay; 5=bell 1 & aux relay; 6=bell 2 & aux relay; 7=bell 1 & bell 2 & aux relay.</p> <p>Press [*] to continue.</p>
<div>010 INPUT TYPE</div> <div>RF Xmitter 3</div> <div> <p>Input types 4 & 5 are valid for certain 5800 Series transmitters only</p> <p>If using input type 02 with a door/window type transmitter, only loop 1 may be used.</p> </div>	<p>Enter the input device type as follows:</p> <ul style="list-style-type: none"> 00 = not used 01 = hardwired 02 = RF motion (RM type) 03 = supervised RF transmitter (RF type) 04 = unsupervised RF transmitter (UR type) 05 = RF button-type transmitter (BR type) 06 = serial number polling loop device (SL type) 07 = DIP switch-type polling loop device 08 = right loop of DIP switch type device 09 = keypad input (code + #73) <p>Right loops refer to the use of the right loop on a 4190WH Zone Expander Module and/or 4278EX PIR, which allow hardwired devices to be monitored by the polling loop.</p> <p>If you are programming hardwired or DIP switch polling loop devices, the summary display appears after completing this entry.</p> <p>NOTE: After programming, refer to the Installation and Setup Guide test section for testing of the RF devices.</p> <p>Press [*] to continue.</p>
<div>010 SMART CONTACT</div> <div>1 = YES 0 = NO</div>	<p>If input type 3 or 6 was selected, this prompt will be displayed. Enter 1 for devices that monitor maintenance signals (ex. 5193SD, 5193SDT) or can be used to limit fault signals in the disarmed state (ex. Quest 2260SN). Otherwise, enter 0.</p> <p>NOTES:</p> <ol style="list-style-type: none"> The Smart Contact option must ONLY be selected for devices that support the feature, otherwise unpredictable results may occur. If using the new 5193SD/SDT V-Plex smoke detectors (or older 5192SD/SDT with the maintenance DIP sw enabled) the "Smart" option must be selected in zone programming or when they enroll unpredictable results may occur if the smoke goes into a High Sens or Low Sens condition.

PROMPT	EXPLANATION
001 Tamper Option none 0	<p>If you selected input type 1, 6, 7, or 8, this prompt displays. If the zone has a tamper switch wired in the loop in addition to a sensor contact, enter the tamper option.</p> <p>Enter 1 if the tamper switch is normally closed (wired in series) with the EOL resistor.</p> <p>Enter 2 if the tamper switch is normally open (wired in parallel) with the EOL resistor.</p> <p>Enter 0 if a tamper switch is not being used in the loop.</p> <p>NOTE: For zone response types 9 or 16 (Fire), the tamper selection must be "0" none.</p>
010 V-PLEX RELAY? 1 = YES 0 = NO	<p>If you selected input type 6, this prompt is displayed. Enter 1 if using a 4101SN Relay Module for this zone. Otherwise enter 0.</p> <p>Press [*] to continue.</p>
010 CONS ECP ADDR (00-30) 01	<p>If you selected input type 09, this prompt is displayed. Enter the ECP address of the keypad that is being used for entry/exit for this access point (00-30).</p> <p>Press [*] to continue.</p>
010 ACCESS POINT (01-15) 01	<p>If you selected input types 06 this prompt is displayed. Enter the access point (01-15) to be controlled by the input type.</p> <p>NOTE: For input type 06, the selected address must be 00.</p> <p>Press [*] to continue.</p>
010 INPUT S/N: XXXX-XXXX L 1	<p>For Serial Number entry and Loop Number entry, do one of the following:</p> <ol style="list-style-type: none"> Transmit two open and close (or close and open) sequences. For a button-type transmitter, press and release the button, wait approximately 4 seconds, then press and release the button a second time. <p>OR</p> <ol style="list-style-type: none"> Manually enter the 7-digit serial number printed on a label on the transmitter, using the Alpha keypad. Then press the [*] key, the cursor moves to the "L" position. You can edit the loop number, if necessary. When the loop number is acceptable, press [*]. <p>OR</p> <ol style="list-style-type: none"> Press key [C] to copy the last serial number enrolled (used when programming a transmitter with several input loops). <p>Press [*] to accept.</p>
010 INPUT S/N: A022-4064 L 1	<p>The cursor will then move to the Loop column (L) with the previously entered/transmitted serial number displayed.</p> <p>Enter the loop number (refer to 5800 Series Transmitters Loop Designations below).</p> <p>To Delete an Existing Serial Number, enter "0" in the loop number field. The serial number will change to "0"s.</p> <p>If "0" was entered in error, simply re-enter the loop number or press [#], and the serial number will return to the display.</p> <p>Press [*] to accept.</p>
010 INPUT S/N: A022-4064 L 1	<p>The system will then check for a duplicate serial/loop number combination.</p> <p>If a duplicate serial/loop number combination is found, the keypad will emit a single long beep, and display the serial number along with a "?" for the loop number, allowing you to re-enter the correct loop number.</p> <p>If the serial/loop number combination is not a duplicate in the system, a display appears showing the serial number and loop number entry.</p> <p>Press [*] to continue.</p>

5800 Series Transmitters Loop Designations

PROMPT	EXPLANATION
<div> XMIT TO CONFIRM PRESS *TO SKIP </div>	Confirmation Option: This prompt only appears if you answered “Yes” at the first prompt. The system enters a confirmation mode so that the operation of the actual programmed input can be confirmed. Activate the loop input or button that corresponds to this zone. At any time during this step, you may press the [*] key on the keypad to save the serial and loop number combination without confirming.
<div> Entd A022-4063 1 Rcvd A022-4064 </div>	<p>If the serial number transmitted <u>does not</u> match the serial number entered, a display similar to the one at the left appears. If the loop number does not match, it is also displayed.</p> <p>If so, activate the loop input or button on the transmitter once again. If a match is not obtained (i.e., summary display does not appear), press the [#] key twice and then enter or transmit the correct serial number.</p>
<div> 010 ZT P RC In L 03 1 3C RF 1s </div>	<p>If the serial number transmitted <u>does</u> match the serial number entered, the system beeps 3 times and a summary display appears, showing that zone's programming. Note that an “s” indicates that a transmitter's serial number has been enrolled.</p> <p>Press [*] to accept the zone information.</p>
<div> ENTER ZONE NO. 000 = QUIT 011 </div>	<p>The system now returns to the “ENTER ZONE NO.” prompt for the next zone.</p> <p>When all zones have been programmed, enter “000” to quit.</p>

After you have enrolled each wireless device, remove ONE of the serial number labels from that device and affix it in the appropriate column on the worksheets provided later in this *Programming Guide*; then enter the other information (zone number, zone type, etc.) relevant to that device.



When you have finished programming all zones, test each using the system's Test Mode. Do not use the Transmitter ID Sniffer Mode. The system checks only for transmission of one zone on a particular transmitter, NOT the zones assigned to each additional loop, and also does not verify polling loop type zones.

Expert Mode Zone Programming

Expert mode allows you to program zones using the minimum number of screens and keystrokes.



Expert Mode Zone Programming does not provide the capability to program some of the zone's attributes, such as Arm w/Fault, Vent Zone, STAY mode, Auto-STAY, Bypass Group, etc. If you want to program a zone for any of these attributes, you must use Zone Programming.

Enter the Programming mode with **[Installer Code] + 8 0 0 0**

Before programming your zones, do the following:

1. Program field **2*00: Number of Partitions**.
2. Enable your RF Receiver in *Device Programming* menu mode.

To program your zones, press ***93** to display the "ZONE PROG?" prompt. Enter "0" (NO) to each prompt until the "EXPERT MODE?" prompt appears.

PROMPT	EXPLANATION
EXPERT MODE? 1 = YES 0 = NO 0	Press 1 to enter Expert mode.
SET TO CONFIRM? 0 = NO 1 = YES 0	This prompt appears once upon entering Expert Mode. If you select "Yes," Confirmation prompts will be displayed after the device's Serial and Loop numbers have been entered later.
Zn ZT P RC In L 001 03 1 10 HW -	A summary display appears, showing zone 1's current programming or default values.
Zn ZT P RC In L 010 03 1 10 RF 1s	Enter the desired 3-digit zone number and press [*] . NOTE: If you want to exit the Expert mode, enter "000" + [*] . If an "s" appears after the loop number, it indicates that the transmitter's serial number has been enrolled. Use the [D] key to enter and duplicate wireless keys (see "Entering Wireless Keys" later)
Zn ZT P RC In L 010 03 1 10 RF -	Enter all zone information except for Loop number, or press "C" to copy the zone information on this screen from the last saved zone (including Loop). ZT = Zone Type P = Partition RC = Report Code In = Input Device Type L = Loop number to which the sensor is connected. NOTE: Pressing the [C] copies the zone information from the last saved zone, which includes the input type. Verify this information is correct for this zone. On this screen: <ul style="list-style-type: none">• Use the [A] key to move to the right.• Use the [B] key to move to left and to back up to "ZT" field. Press [*] to accept the existing or newly-entered zone information.

PROMPT	EXPLANATION
<div> <div>ZN B M V A C E AD</div> <div>010 2 1 1 0 1 1 01</div> </div>	<p>Enter the remainder of the zone's information, or press the [C] key to copy the zone attributes on this screen from the last saved zone.</p> <p>B = Bell/Relay Assignment M = Maintenance (only used if "In" = 3 or 6) V = Do Not Use. Must be set to "0". AC = Access Point (only used if In = 6) E = Do Not Use. Must be set to "0". AD = Address (only used if "In" = 9) If "In" = 9, enter the Device Address</p> <p>NOTE: Pressing the [C] copies the zone attributes from the last saved zone. Verify the attributes for this zone are correct.</p> <p>On this screen:</p> <ul style="list-style-type: none"> Use the [A] key to move to the right. Use the [B] key to move to left and to back up to "V" field. <p>Press [*] to accept existing information.</p>
<div> <div>010 INPUT S/N: L</div> <div>A XXX-XXXX -</div> </div>	<p>If you entered RM, RF, BR, UR or SL for the Input Type, this screen displays. Otherwise the summary screen for the next zone displays.</p> <p>Enter the 7-digit serial number, using one of the following methods:</p> <ol style="list-style-type: none"> Transmit two open and close (or close and open) sequences. For a button-type transmitter, press and release the button, wait approximately 4 seconds, then press and release the button a second time. OR Manually enter the 7-digit serial number printed on a label on the transmitter, using the alpha keypad. Then press the [*] key, the cursor will move to the "L" position. You can edit the loop number, if necessary. When the loop number is acceptable, press [*]. OR Press key [C] to copy the last serial number enrolled (used when programming a transmitter with several input loops). <p>Remember, you can use the [A] key to move to the right or the [B] key to move to the left. You can also use the [#] key to back up without saving.</p>
<div> <div>010 INPUT S/N: L</div> <div>A022-4064 1</div> </div>	<p>Press [*] to accept the serial number and advance to the "L" position (if method "a" or "c" was used), then enter the loop number.</p> <p>If necessary, press the [#] key to back up without saving, and re-enter or edit the serial number before pressing [*] to save</p> <p>The system checks for a duplicate. If a duplicate serial/loop number combination is found, the keypad will emit a single long beep, and display the serial number along with a "?" for the loop number, allowing you to re-enter the correct loop number.</p>
<div> <div>010 INPUT S/N: L</div> <div>A000-0000 1</div> </div>	<p>To Delete an Existing Serial Number, enter "0" in the loop number field. The serial number will change to "0"s.</p> <p>If "0" was entered in error, simply re-enter the loop number or press [#], and the serial number will return to the display.</p>
<div> <div>XMIT TO CONFIRM</div> <div>PRESS *TO SKIP</div> </div>	<p>The prompt to confirm appears. This prompt only appears if you answered "Yes" at the "SET TO CONFIRM?" prompt.</p> <p>The system enters a confirmation mode so that the operation of the actual programmed input can be confirmed. Activate the loop input or button that corresponds to this zone. At any time during this step, you may press the [*] key on the keypad to save the serial and loop number combination without confirming.</p>
<div> <div>Entd A022-4063 1</div> <div>Rcvd A022-4064</div> </div>	<p>If the serial number transmitted <u>does not</u> match the serial number entered, a display similar to the one at the left appears. If the loop number does not match, it also is displayed.</p> <p>If so, activate the loop input or button on the transmitter once again. If a match is not obtained (i.e., summary display for the next zone does not appear), press the [#] key twice and then enter or transmit the correct serial number.</p> <p>Activate the button on the wireless key again after re-entering the serial number.</p>
<div> <div>Zn ZT P RC In L</div> <div>011 00 1 10 00 1</div> </div>	<p>If the serial number transmitted <u>matches</u> the serial number entered, the system beeps 3 times and advances to the summary display for the next zone's programming.</p> <p>After all the zones have been programmed, enter 000 for the zone number to quit.</p>

After you have enrolled each wireless device, remove ONE of the serial number labels from that device and affix it in the appropriate column on the worksheets provided later in this *Programming Guide*; then enter the other information (zone number, zone type, etc.) relevant to that device.

Report Code Programming

All report codes are entered using *#93 Menu Mode Programming*, either through *Report Code Programming*, or through *Zone Programming* while entering other zone information. In the VISTA-128FBPN, reports are divided into six categories. These categories represent the main menu options in *Report Code Programming*. Reports and the categories in which they are found are as follows:

ALARM CODES	RESTR, SUPV. CODES (for groups of 16 zones)	SYSTEM GROUP #1
Zone Alarm Reports	Alarm Restore Trouble Trouble Restore Bypass Bypass Restore	Closing (arm AWAY) Opening (disarm) System Low Battery Low Battery Restore AC Loss AC Restore Periodic Test Power Cancel Program Tamper
SYSTEM GROUP #2	SYSTEM GROUP #3	SYSTEM GROUP #4
Arm STAY Time Set, Log Reset Dialer Queue Overflow Exit Error by Zone Recent Close	Early Open Early Close Late Open Late Close Failed to Open Failed to Close Auto-Arm Failed Schedule Change	Fire Walk-Test Start Fire Walk-Test End Off-Normal

The programming sequence that follows assumes that you will be entering all reports for the system at one time. In actuality, you may skip from one main menu option to another by pressing **0** (N) at each main menu option. Main menu options are highlighted in bold text. To enter report codes, do the following:

Enter Program Mode: **[Installer Code] + 8 0 0 0**. Then press **#93**. Enter **0** (N) at each main menu option until the *Report Code Programming* option is displayed.

PROMPT	EXPLANATION
REPORT CODE PROG 1 = YES 0 = NO 0	Press 1 (Y) to enter to <i>Report Code Programming</i> .
Zone Alarm Reports	
PROMPT	EXPLANATION
ALARM, ID DIGIT? 1 = YES 0 = NO 0	Press [1] (Y) to enter Alarm Report Codes for zones. Press [0] (N) to skip to the next main menu option.
ENTER ZONE NO. 000 = QUIT 001	Enter the zone number for which you are entering the report code. Press [*] to continue.
001 REPORT CODE 1st 00 2nd 00 00	Enter the first digit of the Alarm report code (double-digit entry) and press [*] . Enter the 2nd digit of the Alarm Report code. Press [*] to continue.
ENTER ZONE NO. 000 = QUIT 001	Enter the zone number for which you are entering the report code. When all zone Alarm Codes have been programmed, enter 000 to Quit. Press [*] to continue.
QUIT REPORT MENU 1 = YES 0 = NO 0	If you have completely finished entering report codes, press [1] (Y) to quit <i>Report Code Programming</i> . If you wish to enter other system report codes, enter 0 (N). Press [*] to continue.

Restore/Supervisory Codes

PROMPT	EXPLANATION
RESTR, SUPV. CODE 1 = YES 0 = NO 0	Press [1] (Y) to enter Restore and Supervisory Codes for zones.
ENTER ZN FOR GRP 000 = QUIT 001	Enter one zone for each group of 16 zones (001-016, 017-032, etc.).
ALARM RESTORE GRP 001-016 00	Enter the first digit of the Alarm Restore Report Code for this group of zones (double-digit entry). The second digit (for two-digit reporting formats) is automatically the ID (second) digit of the Alarm Report Code for each zone (if programmed). Press [*] to continue.
TROUBLE GRP 001-016 00	Enter the first digit of the Trouble Report Code for this group of zones (double-digit entry). The second digit (for two-digit reporting formats) is automatically the ID (second) digit of the Alarm Report Code for each zone (if programmed). Press [*] to continue.
TROUBLE RESTORE GRP 001-016 00	Enter the first digit of the trouble restore code (single-digit entry) and press [*]. The second digit (for two-digit reporting formats) is automatically the ID (second) digit of the alarm report code for each zone (if programmed). Press [*] to continue.
BYPASS GRP 001-016 00	Enter the first digit of the Bypass Report Code (double-digit entry) and press [*]. The second digit (for two-digit reporting formats) is automatically the ID (second) digit of the Alarm Report Code for each zone (if programmed). Press [*] to continue.
BYPASS RESTORE GRP 001-016 00	Enter the first digit of the Bypass Restore Report Code (double-digit entry) and press [*]. The second digit (for two-digit reporting formats) is automatically the ID (second) digit of the Alarm Report Code for each zone (if programmed). Press [*] to continue.
ENTER ZN FOR GRP 000 = QUIT 017	Enter one zone for each group of 16 zones. When you are finished entering Restore and Supervisory Codes for all zone groups, enter 000 . Press [*] to continue.
QUIT REPORT MENU 1 = YES 0 = NO 0	If you have completely finished entering report codes, press [1] (Y) to quit <i>Report Code Programming</i> . If you wish to enter other system report codes, enter 0 (N). Press [*] to continue.

System Group #1 Codes

PROMPT	EXPLANATION
SYSTEM GROUP #1? 1 = YES 0 = NO 0	To enter System Group #1 codes, press 1 (Y).
CLOSE 1st 00 2nd 00	Enter the first digit of the Closing (Arm-AWAY) report. Press [*]. Enter the second digit of the report. If the user number is desired as the second digit, enter 01 (not necessary for Contact ID or High Speed formats). Press [*] to continue.

PROMPT	EXPLANATION
	<p>Enter the rest of the codes in the same manner. Other report codes in System Group #1 are:</p> <ul style="list-style-type: none"> • Opening (Disarm) Also, enable this if you desire Callback Requested reports (the panel answers a phone call from the downloader). • System Low Battery • Low Battery Restore • AC Loss • AC Restore • Periodic Test • Power • Cancel – Starting at the end of the Abort Window the period of time in which a user can cancel the alarm is 5 minutes. If an alarm has been previously transmitted, a cancel signal is transmitted if either the alarm system is disarmed or both a disarm and a function key is depressed during the Cancel Window. Additionally, when an alarm cancel has been sent on the keypad within the 5 minutes, the bell will ding momentarily. • Program Tamper <p>Once you have entered these report codes, the system prompts you with the Quit menu.</p>

<div>QUIT REPORT MENU</div> <div>1 = YES 0 = NO 0</div>	<p>If you have completely finished entering report codes, press 1 (Y) to quit <i>Report Code Programming</i>. If you wish to enter other system report codes, enter 0 (N). Press [*] to continue.</p>
---	--

System Group #2 Codes

PROMPT	EXPLANATION
<div>SYSTEM GROUP #2 ?</div> <div>1 = YES 0 = NO 0</div>	<p>To enter System Group #2 codes, press [1] (Y).</p>
<div>STAY</div> <div>1st 00 2nd 00</div>	<p>Enter the first digit of the Arm-STAY report. Press [*]. Enter the second digit of the report. If the user number is desired as the second digit, enter 01 (not necessary for Contact ID or High Speed formats). Press [*] to continue.</p>
	<p>Enter the rest of the codes in the same manner. Other codes in System Group #2 are:</p> <ul style="list-style-type: none"> • Time Set, Log Reset • Dialer Queue Overflow • Exit Error by Zone • Recent Close– A Recent Closing transmission is sent if an alarm occurs within 2 minutes of the expiration of the Exit Time. The user number is included in the Recent Closing transmission when available. <p>Once you have entered these report codes, the system prompts you with the Quit menu.</p>

<div>QUIT REPORT MENU</div> <div>1 = YES 0 = NO 0</div>	<p>If you have completely finished entering report codes, press [1] (Y) to quit <i>Report Code Programming</i>. If you wish to enter other system report codes, enter 0 (N). Press [*] to continue.</p>
---	--

System Group #3 Codes

PROMPT	EXPLANATION
SYSTEM GROUP #3 ? 1 = YES 0 = NO 0	To enter System Group #3 codes, press [1] (Y).
EARLY OPEN 1st 00 2nd 00	Enter the first digit of the Early Opening Report Code. Press [*] . Enter the second digit of the report code. If the user number is desired as the second digit, enter 01 (not necessary for Contact ID or High Speed formats). Press [*] to continue.
	Enter the rest of the codes in the same manner. Other codes in System Group #3 are: <ul style="list-style-type: none">• Early Close• Late Open• Late Close• Failed to Open• Failed to Close• Auto-Arm Failed• Schedule Change Once you have entered these report codes, the system prompts you with the Quit menu.
QUIT REPORT MENU 1 = YES 0 = NO 0	If you have completely finished entering report codes, press [1] (Y) to quit <i>Report Code Programming</i> . If you wish to enter other system report codes, enter 0 (N) Press [*] to continue.

System Group #4 Codes

PROMPT	EXPLANATION
SYSTEM GROUP #4 ? 1 = YES 0 = NO 0	To enter System Group #4 codes, press [1] (YES).
WALK TEST START 1st 00 2nd 00	Enter the first digit of the Fire Walk Test Start Report Code. Press [*] . Enter the second digit of the report code. Press [*] to continue.
	Enter the rest of the codes in the same manner. Other codes in System Group #4 are: <ul style="list-style-type: none">• Fire Walk-Test End.• Off-Normal. Once you have entered these report codes, the system prompts you with the Quit menu.
QUIT MENU MODE? 1 = YES 0 = NO 0	Enter 1 to exit back to normal Programming mode. Enter 0 to stay in Menu mode.

Alpha Descriptors Programming

You can program a user-friendly English language description/location for all protection zones, relays, keypad panics, polling loop short, and RF receiver supervision troubles.

Each description can be composed of a combination of words (up to 3) that are selected from a vocabulary of 244 words stored in memory, and any word can have an "s" or " 's " added to it.

NOTE: Due to the use of 3-digit zone numbers, the first word of the descriptor is limited to 6 characters if you want it to fit on the top line of the display.

In addition, up to 60 installer-defined words can be added to those already in memory. Thus, when an alarm or trouble occurs in a zone, an appropriate description for the location of that zone will be displayed at the keypad.

A custom installer's message can be programmed for each partition which is displayed when the system is "Ready" (e.g., THE PETERSONS').

1. To program alpha descriptors, enter Programming mode, then press **#93** to display "ZONE PROG?"
2. Press **[0]** (NO) twice to display "ALPHA PROG?".
3. Press **[1]** to enter *Alpha Programming*.

There are 6 submenu selections that will be displayed one at a time.

Press **[1]** to select the mode desired.

Press **[0]** to display the next mode available. The alpha menu selections are:

ZONE DESCRIP?	For entering zone descriptors.
DEFAULT SCREEN?	For creating custom message; displayed when system is ready.
CUSTOM WORD?	For creating custom words for use in descriptors.
PART DESCRIP?	For creating 4-character partition names.
EXIT EDIT MODE?	Press [1] to exit back to #93 Menu Mode.

4. Refer to the sections that follow for procedures for adding alpha descriptors.

Zone Descriptors

1. **Select ZONE DESCRIPTOR mode.**

The keypad keys perform the following functions:

- [3] Scrolls both alphabet and actual words in ascending alphabetical order.
- [1] Scrolls both alphabet and actual words in descending alphabetical order.
- [2] Adds or removes an "s" or " 's " to a vocabulary word.
- [6] Switches between alphabet and actual word list; used to accept entries.
- [8] Saves the zone description in the system's memory.
- [#] [#] plus zone number displays the description for that zone.

2. **Enter the zone number to which you want to assign a descriptor.**

For example, key **[*] 001** to begin entering the description for Zone 1, (key **[*] 002** for Zone 2, **[*] 003** for Zone 3, etc.). The following is displayed: * ZN 001 A.

Note that the first letter of the alphabet appears after the zone number, and that the zone number is automatically included with the description.

3. **Enter the descriptor for that zone.**

Use one of two methods as follows:

(Assume, for example, that the desired description for Zone 1 is BACK DOOR.)

- a) Press **[#]** followed by the 3-digit number of the first word from the fixed dictionary shown later in this section (e.g., **[0][1][5]** for BACK).

Press **[6]** in order to accept the word and proceed, or press **[8]** to store the complete descriptor and exit;

or

- b) Select the first letter of the desired description (note that "A" is already displayed). Use the **[3]** key to advance through the alphabet and the **[1]** key to go backward.

Press **[3]** key repeatedly until "B" appears (press **[1]** to go backwards if you happen to pass it), then press **[6]** to display the first available word beginning with "B".

Press **[3]** repeatedly to advance through the available words until the word "BACK" is displayed.



To add an "s" or "'s," if you need to, press **2**. The first depression adds an "s," the second depression adds an "'s," the third depression displays no character (to erase the character), the fourth depression adds an "s," etc.

4. **Accept the word.**

To accept the word, press [6], which switches back to the alphabet list for the next word, or press [8] to store the complete descriptor and then exit.

5. **Select the next word.**

For selection of the next word (DOOR), repeat step 3a (word #063) or 3b, but selecting the word "DOOR."

To accept the word, press [6], which again switches back to alphabet list.

6. **Store the descriptor.**

When all desired words have been entered, press [8] to store the description in memory.

To review the zone descriptors, key [#] plus zone number (e.g., #001).

To edit zone descriptors, key [*] plus zone number (e.g., *001)

7. **Exit Zone Description Mode: enter 000.**

Default Screen (Custom Message Display)

Normally, when the system is in the disarmed state, the following display is present on the keypad.

****DISARMED****
READY TO ARM

Part or the entire above message can be modified to create a custom installer message for each partition. For example, "****DISARMED****" on the first line or "READY TO ARM" on the second line could be replaced by the installation company name or phone number for service.

NOTE: There are only 16 character spaces on each of the two lines.

To create a custom display message, proceed as follows:

1. **Select Default Screen mode.**

The keypad asks for the partition number for this message.

Enter the partition number. Press [*] to accept entry.

The following display appears:

****DISARMED****
READY TO ARM

A cursor is present at the extreme left of the first line (over the first "star"). Press [6] to move the cursor to the right and [4] to move the cursor to the left. Press [7] to insert spaces or erase existing characters.

2. **Create the message.**

For example, to replace "READY TO ARM" with the message "SERVICE 424-0177," proceed as follows:

Press [6] to move the cursor to the right, and continue until the cursor is positioned over the first location on the second line.

Press [3] to advance through the alphabet to the first desired character (in this case, "S"). Press [1] to go backward, when necessary. When the desired character is reached, press [6].

The cursor then moves to the next position, ready for entry of the next character (in this example, "E"). When the cursor reaches a position over an existing character, press [3] or [1] to advance or back up from that character in the alphabet.

Proceed in this manner until all characters in the message have been entered.

3. **Save the message.**

Store the new display message in memory by pressing [8].

4. **The system asks for a new partition number.**

Enter 0 to quit or 1-8 for a new partition number.

Custom Words

Up to 60 installer-defined words can be added to the built-in vocabulary. Each of the 60 "words" can actually consist of several words, but bear in mind that a maximum of 10 characters can be used for each word string.

1. **Select CUSTOM WORD Mode.**

The keys perform the following functions:

[3] Advances through alphabet in ascending order.

[1] Advances through alphabet in descending order.

[6] Selects desired letter; moves the cursor 1 space to the right.

[4] Moves the cursor one space to the left.

[7] Inserts a space at the cursor location, erasing any character at that location.

[8] Saves the new word in the system's memory.

[*] Returns to Description Entry Mode.

2. **Enter the custom word number (01-60) you want to create.**

For example, if you are creating the first word (or word string), enter 01; when creating the second word, enter 02, and so on. A cursor now appears at the beginning of the second line.

3. Type the word using one of two methods as follows:

- a) Press [#], followed by the 2-digit entry for the first letter you would like to display (e.g., **65** for "A").
When the desired character appears, press **[6]** to select it. The cursor will then move to the right, in position for the next character. Press [#] plus the 2-digit entry for the next letter of the word.

or

- b) Press **3** to advance through the list of symbols, numbers, and letters.
Press **1** to move back through the list.
When you have reached the desired character, press **[6]** to select it. The cursor then moves to the right, in position for the next character.

4. Repeat step 3 to create the desired custom word (or words).

Press **[4]** to move the cursor to the left if necessary.

Press **[7]** to enter a blank (or to erase an existing character).

Each word or word string cannot exceed 10 characters.

5. Save the word by pressing [8].

This returns you to the "CUSTOM WORD?" display. The custom word (or string of words) is automatically added to the built-in vocabulary at the end of the group of words beginning with the same letter.

Custom words are retrieved as word numbers 255 to 314 for words 1 to 60, respectively, when using method 3a to enter alpha descriptors.

When using method 3b to enter alpha descriptors, each word appears at the end of the group of words that begin with the same letter as it does.

6. Repeat steps 2 through 6 to create up to a maximum of 60 custom words (or word strings).

7. Exit Custom Word Mode by entering 00 at the "CUSTOM WORD" prompt.

Partition Descriptors

1. Select "Part DESCRIPT." Mode.

The system asks for the partition number desired. Enter the number as a single-key entry **1-8**.

2. Follow the same procedure as for custom words.

NOTE: The partition descriptors are limited to 4 characters (e.g., WHSE for warehouse).

Alpha Descriptor Vocabulary

(For entering alpha descriptors. To select a word, press [#] followed by the word's 3-digit number.)

NOTE: This vocabulary is not to be used for relay voice descriptors. See the *Relay Voice Descriptors* section when programming relay voice descriptors.

000 (Word Space)	058 DIALER 2	112 JEWELRY	163 QUAD	• 211 TOOL
• 001 AIR	• 059 DINING	• 113 KITCHEN	164 COMMUNICATOR	212 TRANSMITTER
• 002 ALARM	061 DISPLAY	• 114 LAUNDRY	• 165 REAR	213 TRAP
004 ALLEY	062 DOCK	• 115 LEFT	166 RECREATION	214 TRIGGERS
005 AMBUSH	• 063 DOOR	116 LEVEL	167 REFRIG	202 UNIT
006 ANTENNA	• 065 DOWN	• 117 LIBRARY	168 REFRIGERATION	• 216 UP
• 007 AREA	• 066 DOWNSTAIRS	• 118 LIGHT	130 RELAY	• 217 UPPER
• 008 APARTMENT	067 DRAWER	119 LINE	169 RELAY 1	• 218 UPSTAIRS
009 ART	• 068 DRIVEWAY	120 LIQUOR	133 REMOTE	• 219 UTILITY
• 010 ATTIC	069 DRUG	• 121 LIVING	136 RESTAURANT	220 VALVE
011 AUDIO	• 070 DUCT	• 122 LOADING	003 RESTROOM	221 VAULT
012 AUX	• 071 EARTH	064 LOBBY	170 RF	222 VIBRATION
013 AUXILIARY	072 EAST	• 083 LOCAL	• 171 RIGHT	223 VOLTAGE
• 015 BACK	073 ELECTRIC	123 LOCK	• 172 ROOM	224 WALL
• 016 BAR	035 ELEVATOR	124 LOOP	173 ROOF	225 WAREHOUSE
017 BARN	074 EMERGENCY	125 LORRA	174 SAFE	226 WASH
• 018 BASEMENT	075 ENTRY	126 LOW	175 SCREEN	215 WATERFLOW
• 019 BATHROOM	• 076 EQUIPMENT	• 127 LOWER	142 SECURITY	• 227 WEST
• 021 BEDROOM	077 EXECUTIVE	• 128 MACHINE	176 SENSOR	• 228 WINDOW
022 BELL	• 078 EXIT	131 MAIN	• 177 SERVICE	229 WINE
023 BELL 1	079 EXTERIOR	089 MAN_PULL	• 178 SHED	• 230 WING
024 BELL 2	• 080 FACTORY	• 132 MASTER	187 SHIPPING	• 014 WOMEN
• 025 BLOWER	081 FAILURE	• 134 MEDICAL	179 SHOCK	231 WORK
• 026 BOILER	082 FAMILY	135 MEDICINE	• 180 SHOP	232 XMITTER
027 BOTTOM	• 084 FENCE	• 020 MEN	181 SHORT	233 YARD
028 BOX	085 FILE	093 MIDDLE	182 SHOW	234 ZN-1
029 BREAK	• 086 FIRE	129 MODULE	• 183 SIDE	• 235 ZONE
• 030 BUILDING	• 087 FLOOR	137 MONEY	184 SKYLIGHT	• 236 0
031 BURNER	088 FLOW	138 MONITOR	185 SLIDING	• 237 1
032 CABINET	• 090 FOYER	• 140 MOTION	• 186 SMOKE	• 238 1ST
034 CAMERA	091 FREEZER	141 MOTOR	• 188 SOUNDER	• 239 2
036 CASE	• 092 FRONT	• 143 NORTH	• 189 SOUTH	• 240 2ND
037 CASH	094 FURNACE	144 NURSERY	190 SPRINKLER	• 241 3
038 CCTV	095 GALLERY	• 145 OFFICE	191 STAIRWAY	• 242 3RD
039 CEILING	• 096 GARAGE	146 OIL	• 192 STATION	• 243 4
040 CELLULAR	• 097 GAS	• 147 OPEN	194 STORE	• 244 4TH
• 041 CENTRAL	098 GATE	148 OPENING	• 195 STORAGE	• 245 5
042 CIRCUIT	• 099 GLASS	• 149 OUTSIDE	196 STORY	• 246 5TH
043 CLIP	100 GROUND	150 OVERFLOW	198 STRIKE	• 247 6
• 044 CLOSED	101 GUEST	151 OVERHEAD	193 STROBE	• 248 6TH
045 COIN	102 GUN	• 153 PANIC	199 SUMP	• 249 7
046 COLD	• 103 HALL	152 PARKING	200 SUPERVISED	• 250 7TH
047 COATROOM	• 104 HEAT	154 PASSIVE	201 SUPERVISION	• 251 8
048 COLLECTION	105 HIGH	• 155 PATIO	203 SWITCH	• 252 8TH
049 COMBUSTION	106 HOLDUP	156 PERIMETER	197 SYSTEM	• 253 9
• 050 COMPUTER	• 139 HOOD	• 157 PHONE	204 TAMPER	• 254 9TH
051 CONTACT	• 052 HORN_CKT	158 PHOTO	205 TAPE	• 255 Custom Word 1
• 033 CORRIDOR	107 HOUSE	159 POINT	206 TELCO	to
053 DELAYED	060 HVAC	160 POLICE	207 TELEPHONE	314 Custom Word 60
• 054 DEN	• 108 INFRARED	161 POOL	208 TELLER	
055 DESK	• 109 INSIDE	• 162 POWER	• 209 TEMPERATURE	
• 056 DETECTOR	110 INTERIOR		210 THERMOSTAT	
057 DIALER 1	111 INTRUSION			

CHARACTER (ASCII) CHART

(For Adding Custom Words)

32 (space)	42 *	52 4	62 >	72 H	82 R
33 !	43 +	53 5	63 ?	73 I	83 S
34 "	44 ,	54 6	64 @	74 J	84 T
35 #	45 -	55 7	65 A	75 K	85 U
36 \$	46 .	56 8	66 B	76 L	86 V
37 %	47 /	57 9	67 C	77 M	87 W
38 &	48 0	58 :	68 D	78 N	88 X
39 '	49 1	59 ;	69 E	79 O	89 Y
40 (50 2	60 <	70 F	80 P	90 Z
41)	51 3	61 =	71 G	81 Q	

NOTE: This factory-provided vocabulary of words is subject to change.

Device Programming

This menu is used to program keypads, receivers, and relay modules, etc.



Device Address **00** is always set as an alpha keypad assigned to Partition 1 with no sounder suppression options, and these settings cannot be changed.

From Data Field Programming mode, press **#93** to display "ZONE PROG?" Press **[0]** repeatedly to display "DEVICE PROG?"

PROMPT		EXPLANATION											
<div>DEVICE PROG? 1=YES 0=NO0</div>		Press [1] to enter <i>Device Programming</i> .											
<div>DEVICE ADDRESS 01-30, 00=QUIT01</div>		<p>The device address identifies the device to the control. Enter the 2-digit device address number to match the device's physical address setting (01-30).</p> <p>Press [*] to accept entry.</p>											
<div>DEVICE TYPE 00</div>		<p>Select the type of addressable device as follows:</p> <table><tr><td>00 = device not used</td><td>06 = communicator</td></tr><tr><td>01 = alpha keypad (6160/6160CR-2)</td><td>09 = Do Not Use</td></tr><tr><td>03 = RF receiver (5881ENHC, 5883H)</td><td>10 = Do Not Use</td></tr><tr><td>04 = output relay module (4204)</td><td>12 = RIS (Remote Interactive Services)</td></tr><tr><td>05 = Do Not Use</td><td></td></tr></table> <p>Press [*] to accept entry.</p>		00 = device not used	06 = communicator	01 = alpha keypad (6160/6160CR-2)	09 = Do Not Use	03 = RF receiver (5881ENHC, 5883H)	10 = Do Not Use	04 = output relay module (4204)	12 = RIS (Remote Interactive Services)	05 = Do Not Use	
00 = device not used	06 = communicator												
01 = alpha keypad (6160/6160CR-2)	09 = Do Not Use												
03 = RF receiver (5881ENHC, 5883H)	10 = Do Not Use												
04 = output relay module (4204)	12 = RIS (Remote Interactive Services)												
05 = Do Not Use													
Alpha Keypad													
PROMPT		EXPLANATION											
<div>01 CONSOLE PART. 1</div>		<p>If you selected device type 01 (alpha keypad), this prompt appears. Enter the addressable device's default partition number (1 to maximum number of partitions programmed for system in field 2*00). This is the primary partition for the device. Enter 9 to make this keypad a "Master" keypad for the system.</p> <p>Press [*] to accept entry.</p>											
<div>01 SOUND OPTION 00</div>		<p>If you entered device type 01 (alpha keypad), this prompt appears. Keypads can be individually programmed to suppress arm/disarm beeps, entry/exit beeps and chime mode beeps. This helps prevent unwanted sounds from disturbing users in other areas of the premises.</p> <p>Enter a number 0-3 for the keypad sounding suppression options desired for the keypad as follows:</p> <table><tr><td>0 = no suppression</td></tr><tr><td>1 = suppress arm/disarm & entry/exit beeps</td></tr><tr><td>2 = suppress chime mode beeps only</td></tr><tr><td>3 = suppress arm/disarm, entry/exit and chime mode beeps</td></tr></table> <p>Press [*] to accept entry.</p>		0 = no suppression	1 = suppress arm/disarm & entry/exit beeps	2 = suppress chime mode beeps only	3 = suppress arm/disarm, entry/exit and chime mode beeps						
0 = no suppression													
1 = suppress arm/disarm & entry/exit beeps													
2 = suppress chime mode beeps only													
3 = suppress arm/disarm, entry/exit and chime mode beeps													
<div>01 KEYPAD GLBL? 0</div>		<p>If you entered device type 01 (alpha keypad), this prompt appears. Each keypad can give users with access to multiple partitions the ability to arm and disarm those partitions from it. To enable this keypad for global arming/disarming, enter 1. To prevent the ability to use this keypad for global arming/disarming, enter 0.</p> <p>Press [*] to accept entry.</p>											
<div>01 AUI ? 1 = YES 0 = NO0</div>		<p>Do Not Use. Must be set to "0".</p> <p>Press [*] to accept entry.</p>											

RF Expander

PROMPT	EXPLANATION
01 RF EXPANDER HOUSE ID 00	If you selected device type 03 (RF receiver), this prompt appears. Enter the 2-digit House ID (00-31). Press [*] to accept entry.

Output Relay Module

PROMPT	EXPLANATION
01 SUPERVISED CF? 0	<p>If you selected device type 04 (relay module), this prompt appears. Enter 1 if the unit is a 4204CF. If not, enter 0. If you enter 1, only Relay 1 (Output A) and Relay 3 (Output B) on each module may be programmed for functions.</p> <p>NOTE: For Commercial Fire installations, only one notification appliance module may be used, and only one notification appliance output (A or B) may be used on that module.</p> <p>Press [*] to accept entry.</p>

Communicator

If you selected device type 6, the 6160/6160CR-2 Keypad functions similarly to the Programming Tool. See *Figure 1* for the functions of the keys on the 6160CR-2.

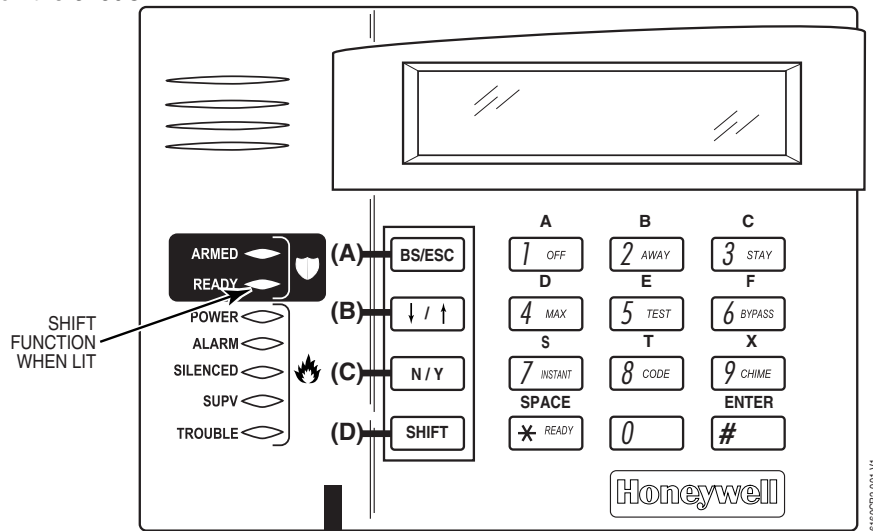

Figure 1: 6160CR-2 Key Functions for Programming the Communicator

Each key has two possible functions: a normal function and a SHIFT function. To perform a normal key function, simply press the desired key. To perform a SHIFT key function, press SHIFT key, then press desired function key.

Normal and SHIFT key Functions:

Key	Normal Key Function	SHIFT Key Function
BS/ESC	[BS]: Press to delete entry Also, can reset EEPROM defaults *	[ESC]: Press to quit Program Mode
↓/↑	[↓]: Scroll down programming	[↑]: Scroll up programming
N/Y	[N]: Press for "NO" answer	[Y]: Press SHIFT-Y for "YES" answer
SHIF T	Press before pressing a SHIFT key function. Will light READY LED. LED goes out once a key is pressed. Press again for each SHIFT function desired.	
1/A	[1]: For entering the number 1	[A]: Used for entering C.S. ID number
2/B	[2]: For entering the number 2	[B]: Used for entering C.S. ID number
3/C	[3]: For entering the number 3	[C]: Used for entering C.S. ID number
4/D	[4]: For entering the number 4	[D]: Used for entering C.S. ID number
5/E	[5]: For entering the number 5	[E]: Used for entering C.S. ID number
6/F	[6]: For entering the number 6	[F]: Used for entering C.S. ID number
7/S	[7]: For entering the number 7	[S]: Not used
8/T	[8]: For entering the number 8	[T]: Not used
9/X	[9]: For entering the number 9	[X]: No SHIFT function
/SPACE	[]: Not used with 7845i-ent	[SPACE]: Not used
0	[0]: For entering the number 0	No SHIFT function
#/ENTER	[#/ENTER]: Press to accept entries	No SHIFT function

* Active only when the "REVIEW?" prompt is displayed.

The 6160/6160CR-2 Keypad displays the following prompts, which are sent by the Communicator to the control.

NOTE: These prompts are for the 7845i-ent Communicator only. If you are using a different communicator, refer to the communicator's instructions for the correct prompts.

PROMPT	EXPLANATION
DEVICE ADDRESS	Enter the device address of the Communicator. The default address is 3.
ID # (1234)	Enter the 4-digit customer account number, 0001-9999 . This ID number will appear in the messages generated by the Communicator. Messages generated by the panel and transmitted by the Communicator will contain the ID number programmed into the panel. The Communicator and the panel should have the same ID number, if possible.
 <p>If a different 4-digit customer account number is used in the Communicator that is programmed into the alarm control, the Communicator will transmit Communicator-specific messages (power-on reset, AC fail, etc.) using the Communicator customer number, and alarm messages using the control panel's customer number. If these numbers are different, you will be billed for two AlarmNet Communicator accounts.</p>	
PROMPT	EXPLANATION
En.AlarmNetI Y/N	Press [Y] to enable alarm delivery via the Internet to an AlarmNet central station. Press [N] to disable AlarmNet-i functionality.
AES Encrypt. Y/N (N)	Press [Y] to use the AES Encryption method. Press [N] to use the Blowfish Encryption.
Web Port (433)	Using the keypad, enter Port (443).
Use Mstr Act [Y/N] (N)	Press [Y] to use the account information assigned for Remote Access. Press [N] to use AlarmNet-i specific account information.
Primary City ID	Enter the 2-digit primary city code, 01-99 (decimal).
Primary CS ID	Enter the primary central station's system ID number, 01-FE.
Primary Sub ID	Enter the 4-digit customer account number, 0001-9999.
En. 2nd CS Y/N	Press [Y] if redundant reporting to a second central station is desired. Press [N] if not desired.
2nd City ID	Enter the 2-digit secondary city code, 01-99 (decimal).
2nd CS ID	Enter the secondary central station's system ID number, 01-FE.
2nd Sub ID	Enter the secondary 4-digit customer account number, 0001-9999.
Enable DW Y/N (N)	Press [Y] to enable Direct Wire Downloading over IP. Press [N] to disable Direct Wire Downloading over IP.

PROMPT	EXPLANATION
Supervision (24 Hour)	<p>Choices: 24 hours, 1 hour, US UL Line 6 min, CN UL Line Lvl 3 (3 min.), US UL Line 90 (seconds), CN UL Line Lvl 4 (90 seconds), CN UL Line Lvl 5 (75 seconds), None.</p> <p>NOTE: For Commercial Fire installations must be set to 90 seconds.</p> <p>The 7845i-ent sends a supervision message once during the supervision period. AlarmNet transmits a communications failure alarm to the central station if the supervision message is not received within the period.</p> <p>To scroll through the available choices:</p> <ul style="list-style-type: none"> • Press the [space] key to scroll forward through the list of choices. • Press the [backspace] key to scroll back through the list if the desired entry has scrolled past. <p>Press the [Enter] key to select the time displayed.</p>
Old Alarm Time (10 Minutes)	<p>The old alarm time sets how long an undeliverable alarm is retried for delivery to AlarmNet. If the message is not validated, it is retried until the old alarm time is reached or the message is validated. The choices available are: 10 Min., 15 Min., 30 Min., 1Hr, 2Hr, 4Hr, 8Hr, 12Hr and 24Hr. To scroll through the available choices:</p> <ul style="list-style-type: none"> • Press the [space] key to scroll forward through the list of choices. • Press the [backspace] key to scroll back through the list if the desired entry has scrolled past. <p>Press the [Enter] key to select the time displayed.</p>
Fault Time (mins) (05)	<p>Enter the time delay (01-99 minutes) before the 7845i-ent notifies the control panel that there is loss of contact with the network, or enter "00" if you do not want the 7845i-ent to alert the control panel of loss of contact with the network. The 7845i-ent will alert the control panel of the loss of contact via a dedicated status message. Refer to Table 3-5 in this Section for more information regarding the ECP Status Codes.</p>

Output Programming

The system supports up to 96 outputs. Outputs can be used to perform many different functions and actions. Each output must be programmed to begin one of four types of ACTIONS at a designated START event, and end that ACTION at a designated STOP event. The options used to start and stop these devices are described below, followed by the actual screen prompts and available entries.

NOTE: If you are using outputs on the polling loop (e.g., 4101SN) no more than 20 of the polling loop outputs may be programmed for the same START or STOP condition. Also, if you are using ZONE # for the START of a polling loop output and want that output to stop when the same zone restores, the STOP programming MUST BE BLANK.

If you are using Zone Type 17 (Waterflow) or 18 (Fire Supervisory) to trigger an output, you must program an Event for the START (alarm, trouble, etc.). All other Zone Type/System Operations do not require an Event.

The letter(s) in parentheses after each function described below, such as (A) after ACTION, are those that appear in the various summary displays of programmed data during programming.

- ACTION (A)** The "ACTION" of the device is how the device will respond when it is activated by the "START" programming. You may want the device to activate momentarily, to pulse on and off continuously, or to remain activated until some other event occurs to stop it. There are five different action choices:
- ACTIVATE for 2 SECONDS and then reset. If selected, it is not necessary to program a stop parameter.
 - ACTIVATE and REMAIN ACTIVATED until stopped by some other event.
 - PULSE ON and OFF until stopped by some other event.
 - NO RESPONSE when the device is not used.
 - TOGGLE on and off alternately with each activation of event. **Do not program a stop parameter as this may cause unpredictable results.**

START (STT) The "START" programming determines when and under what conditions the device is activated. The following START options are available:

- 1) **EVENT (EV)** is the condition (alarm, fault, trouble) that must occur to a zone or group of zones (zone list) in order to activate the device. These conditions apply **only** when a zone list is used. The different choices for "EVENT" are listed below and in "Programming Relays" later in this section.
 - ALARM Action begins upon any alarm in an assigned zone in the zone list.
 - FAULT Action begins upon any opening of an assigned zone in the zone list.
 - TROUBLE Action begins upon any trouble condition in an assigned zone in the zone list.
 - NOT USED Action is not dependent upon one of the above events.

ZONE LIST (ZL) is a group of zones to which the "EVENT" applies in order to activate a particular device. Note that there are a total of 15 zone lists that can be programmed; when the selected EVENT (alarm, fault or trouble) occurs in **any** zone in the selected "Start" ZONE LIST (01-15), activation of the selected device will START.

- 2) **ZONE #** A specific zone going into alarm, fault, trouble, or restore (Event programming) can be used to start the relay action. Enter the 3-digit zone number (000-128).
- 3) **ZONE TYPE/SYSTEM OPERATION (ZT)**. If all zones to be used to start the device have the same response type, and there are no other zones of this type that are **not** to activate this device, then "ZONE TYPE" may be used instead of a "ZONE LIST" and "EVENT" to activate the device.

If a system operation, such as "DISARMING" or "ANY FIRE ALARM," is to activate the device, enter the appropriate choice under the "ZONE TYPE" option.

The "ZONE TYPE/SYSTEM OPERATION" option functions independently of the "EVENT/ZONE LIST" combination.

If a specific "ZONE TYPE" is chosen, any zone of that response type going into alarm, trouble, or fault will cause the device to activate as selected in "ACTION." If the same "ZONE TYPE" is also chosen for the STOP programming, any zone of that type that *restores* will de-activate the device.

If a "SYSTEM OPERATION" is chosen, that operation will cause the device to activate as selected in "ACTION." The different choices for "ZONE TYPE" and "SYSTEM OPERATION" are listed in "Programming Relays" later in this section, and on the Programming Form.

- 4) **PARTITION NO. (P)**. The device's "Start" ZONE TYPE/SYSTEM OPERATION may be limited to an occurrence on one partition (1-8), or any partition (0).

STOP (STP): The "STOP" programming determines when and under what conditions the device is de-activated. The following options are available:

- 1) **RESTORE ZONE LIST (ZL)**. If a "ZONE LIST" is used as the "Stop" event, the device de-activates when **all** the zones in that list restore from a previous fault, trouble, or alarm condition. This occurs regardless of what is programmed to "START" the device; therefore, a "RESTORE ZONE LIST" is normally only used when a "ZONE LIST" is used to start the device.

- 2). **ZONE TYPE/SYSTEM OPERATION (ZT).** Instead of using a "RESTORE ZONE LIST," you can select a specific zone (response) type or system operation action to de-activate the device.
If you choose a specific "ZONE TYPE," any zone of that response type that restores from a previous alarm, trouble, or fault condition will cause the device to de-activate.
If you choose a "SYSTEM OPERATION," that operation causes the device to de-activate. The different choices for "ZONE TYPE" and "SYSTEM OPERATION" are listed in "Programming Relays" later in this section, and in the Programming Form.
- 3) **PARTITION NO. (P).** The device's "Stop" Zone Type/System Operation may be limited to an occurrence on one partition (1-8), or on any partition (0).

The "ZONE TYPE/SYSTEM OPERATION" option functions independently of the "RESTORE/ZONE LIST" combination.

Output Devices Programming

From Data Field Programming Mode, press **#93** to display the "ZONE PROG?" prompt. Press **[0]** (NO) to each menu option until the "OUTPUT PGM?" prompt appears. Press **[1]** (YES).

While in this mode, press **[*]** to advance to next screen. Press **[#]** to back up to the previous screen.

PROMPT	EXPLANATION
ENTER RELAY # (00=QUIT) 01	Enter the relay (output device) identification number 01-96 . This is a reference number only, used for identification purposes. The actual module address and relay number on the module are programmed in the last two prompts. Press [*] to continue.
02 A EV ZL ZT P STT 0 0 00 00 0	Press [*] to continue.
02 A ZL ZT P STOP 0 00 00 0	The keypad displays a summary STOP screen. Press [*] to continue.
02 RELAY ACTION NO RESPONSE 0	The Relay Action is the way in which the relay will respond when activated by the "start" event. Enter the desired action for this relay as follows: 0 =not used; 1 =close for 2 secs.; 2 =stay closed; 3 =pulse on/off; 4 =toggle on and off alternately NOTE: For options 1 and 4, do not program a "Stop" parameter.
02 START EVENT NOT USED 0	An output may be activated by an Event/Zone List combination, and/or by a Zone Type/System Operation. For an Event/Zone List combination, enter the event code as follows: 0 =not used; 1 =alarm; 2 =fault; 3 =trouble NOTE: An Event is required for Zone List, Zone Number and Zone Types 17 and 18. If you are not using a Zone List to activate the relay, enter 0 . Press [*] to continue.
02 START: ZN LIST 00	A zone list is a set of zones that can be used to initiate the start or stop relay action. If a zone list is being used to start this relay action, enter the zone list number, 1-15 . If a zone list is not being used, enter 0 . Press [*] to continue.
02 START: ZONE # 000	A specific zone can be used instead of or in addition to an Event/Zone List or Zone Type/System Operation combination to start the relay action. Enter the 3-digit zone number. Press [*] to continue.
02 START: ZN TYPE NO RESPONSE 00	A Zone Type/System Operation can be used instead of or in addition to an Event/Zone List combination or a specific zone to start the relay action. If a Zone Type/System Operation is being used, enter the 2-digit code as listed in the table that follows. Press [*] to continue.

Choices for Start/Stop Zone Types and System Operations:

00 = No Response (Not Used)	22 = Disarming (Code + Off)	43 = Communication failure
01 = Entry/Exit #1	23 = No Alarm Response	44 = RF Low Battery
02 = Entry/exit #2	27 = Access Point (allows more than one relay to be controlled by activation if access point request) - Not Used	45 = Polling Loop Failure
03 = Perimeter	28 = MLB Supervision - Not Used	47 = Console Failure
04 = Interior Follower	29 = Momentary Exit - Not Used	51 = RF Receiver Failure
05 = Trouble Day/Alarm Night	30 = On Second Code + Off	52 = Kissoff
06 = 24-Hr. Silent	31 = End of Exit Time	54 = Smoke Detector Reset
07 = 24-Hr. Audible	32 = Start of Entry Time	55 = Disarm + 1 Minute
08 = 24-Hr. Auxiliary (Not for Medical Use)	33 = Any Burglary Alarm	56 = XX Minutes (enter XX in field 1*74) *
09 = Fire Alarm or Trouble	34 = Code + [#] + 71 K0ey Entry	57 = YY Seconds (enter YY in field 1*75) *
10 = Interior W/Delay	35 = Code + [#] + 72 Key Entry	58 = Duress
12 = PLM Supervision - Not Used	36 = At Bell 1 Timeout **	
13 = Remote P/S	37 = 2x Bell 1 Timeout **	60 = Audio Alarm Verification (must be selected for both START and STOP operation)
14 = CO Detector Alarm	38 = Chime	61 = Code + [#] + 67
16 = Fire With Verification	39 = Fire Alarm	62 = Bell 2 Timeout
17 = Waterflow*****	40 = Bypassing	63 = Auxiliary Relay Timeout
18 = Fire Supervisory	41 = AC Power Fail	
19 = 24-Hour Trouble	42 = System Battery Low	
20 = Arming-STAY***		
21 = Arming-AWAY****		

* Stop condition only

** Or at disarming, whichever occurs earlier

*** The output also activates when the partition is armed in the INSTANT mode

**** The output also activates when the partition is armed in the MAXIMUM mode

***** Use an event of fault or alarm as the START option



If you are using options 56 and/or 57 (usually as the STOP Zone Type), you must program data fields 1*74 and 1*75 for the respective relay timeouts for minutes and seconds.



Do not use a zone programmed with an RF Button (Input Type BR) to STOP a relay. The system will not deactivate the relay.

PROMPT	EXPLANATION
02 STOP: ZN LIST 00	If a zone list is being used to stop this relay action, enter the zone list number, 1-15 . The restore of a zone on the zone list stops the relay. If a zone list is not being used, enter 0 . Press [*] to continue.
02 STOP: ZN TYPE NO RESPONSE 00	If a Zone Type/System Operation is being used to stop the relay action, enter the 2-digit code listed in the Choices for Start/Stop System Operation chart. NOTE: If a 4204CF is being used, the stop action for a NAC must be programmed as zone type 62, Bell 2 Timeout. Only one relay of the 4204CF may be used for this function. Press [*] to continue.
02 STOP: PARTN ANY PARTITION 0	This is the partition to which the stop condition will be limited. Enter 0 for any partition. Enter 1-8 for specific partition number. Press [*] to continue.
02 RELAY GROUP 00	Relays may be grouped for common activation by time-driven events (commands 06-10). Enter 00 (no group) or 01-15 for a specific group number. Press [*] to continue.
02 FIRE BELL 1=YES 0=NO 0	Enter 1 only if this output is to be used to activate a fire alarm sounder. Press [*] to continue.
02 RESTRICTION 1=YES 0=NO 0	The system may have some devices that are not intended to be under end user control, such as relays activating fire doors or machinery. NOTE: #70 must be set to yes for Commercial Fire installations. Enter 1 if the end user will be restricted from accessing this relay group. Press [*] to continue.

PROMPT	EXPLANATION
02 RELAY TYPE V-PLEX 0	Enter 0 for V-Plex (polling loop) devices. Enter 1 for (ECP) relay modules (4204/4204CF). Press [*] to continue.
02 V-PLEX ZONE # 000	For polling loop trigger outputs (4101SN), enter the protection zone number (001-128) linked to each output, if used. Be sure to enroll the module's serial number (see Zone Programming). Press [*] to continue.
02 ECP ADDRESS 00	If you selected 1 or 3 for (4204/4204CF), enter the actual module's address (01-15 – 4204/4204CF) as set by its DIP switches. Up to 8 4204/4204CF modules can be installed in a system. Press [*] to continue.
02 MODULE RELAY# 0	For 4204 Relay Outputs, enter the specific relay number on that module (1-4). For 4204CF outputs, enter only module relay number 1 (Output A) or relay number 3 (Output B). These are the only two programmable relays on the 4204CF Module. Press [*] to continue. The keypad will display the Start and Stop summary screens again. Press [*] to continue.

When all relays have been programmed, enter **00** at the "ENTER RELAY NO." prompt.

If you are defining a zone list, continue to the next section. If not, enter **00** + [*****] at the next two prompts. You will then be asked "Quit Menu Mode?" Enter **1** for "Yes," **0** for "No." Then enter ***99** to exit programming completely.

If supervision of the 4204CF Relay Output is desired, enter a response type for that output's corresponding supervisory zone. This is equal to 600 + [Relay ID No.]. For example, if you are programming Relay ID No. 1, the relay's supervisory zone 601. Program this zone with response type 05 (Day/Night) in *Zone Programming*.

Zone List Programming

After all relays have been programmed, upon entering **00** at the "ENTER RELAY NO." prompt, you are asked to enter a zone list. If a zone list number was used to start or stop a relay, you must define the zones belonging to that list as follows:

PROMPT	EXPLANATION
ENTER Zn LIST ? 00=QUIT 00	Enter the zone list number 01-15 . Enter 00 to quit.
01 ADD ZONE # 000=QUIT 000	Using 3-digit entries enter each zone to be included in this zone list. Press [*] after you enter each zone number. When you have entered all zones, enter 000 . Press [*] to continue.
01 Del Zn LIST ? 1=YES 0=NO 0	Enter 0 to save this zone list. Enter 1 to delete it.
01 DEL ZONES ? 1=YES 0=NO 0	Enter 1 to delete one or more zones in that zone list. Enter 0 if no changes are necessary. If you enter 1 , the following screen appears; otherwise, the "Enter Zone LIST" prompt reappears.
01 Zn to DELETE ? 000=QUIT 000	Enter each zone number to be deleted from the zone list, pressing [*] after each number.
VIEW Zn LIST ? 00=QUIT 00	This display appears if you pressed 00 at the "Enter Zone LIST" prompt. Enter the zone list number that you wish to view. Press [*] to continue.
01 ASSIGNED ZONE 000=QUIT 000	Press [*] to scroll through all zones in that list. Enter 000 + [*] to quit. Press [1] to exit Menu Mode. Press *99 to exit Program Mode.

Relay Voice Descriptors

Each voice descriptor can consist of up to 3 words selected from the Relay Voice Descriptors and Custom Word Substitutes Vocabulary list (later in this section).



The index numbers from this vocabulary list are to be used for relay voice descriptors only. For normal system voice annunciation (e.g., alarms, troubles, status), use the highlighted words in the alpha vocabulary list in the *Alpha Programming* part of this guide.

To enter relay voice descriptors, do the following:

- 1. From Data Field Programming mode, press **#93** to display the "ZONE PROG?" prompt.
- 2. Press **[0]** (NO) to each menu option until the "RLY VOICE DESCR?" prompt is displayed. Follow the instructions below. While in this mode, press **[*]** to advance to next screen. Press **[#]** to back up to previous screen.

PROMPT	EXPLANATION
RLY VOICE DESCR? 1=YES 0=NO 0	Press [1] to program voice descriptors for relays.
ENTER RELAY NO. 00=QUIT 01	Enter the 2-digit relay number (01-32) for the relay desired, or enter 00 to quit Relay Voice Descriptor Programming Mode. Press [*]
01 ENTER DESC d1	From the Relay Voice Descriptors and Custom Word Substitutes Vocabulary list, enter the 3-digit index number for the first word of the relay descriptor phrase. Press [*] to accept entry.
01 ENTER DESC d2	From the Relay Voice Descriptors and Custom Word Substitutes Vocabulary list, enter the 3-digit index number for the second word of the relay descriptor phrase. If second word is not desired, press [000] . Press [*] to accept entry.
01 ENTER DESC d3	From the Relay Voice Descriptors and Custom Word Substitutes Vocabulary list, enter the 3-digit index number for the third word of the relay descriptor phrase. If third word is not desired, press [000] . Press [*] to accept entry. The "ENTER RELAY NO." prompt appears. Enter the next relay number to be programmed. When you have programmed all output devices, enter 00 to quit. Enter *99 to exit Program Mode.

Relay Voice Descriptors and Custom Word Substitutes Vocabulary

Word	Index	Word	Index	Word	Index	Word	Index	Word	Index
Air	116	Device	060	Gas	138	Off	011	Smoke	024
Alarm	255	Dim	163	Glass	139	Office	147	South	155
And	067	Dining	031	Hall	050	On	058	Stairs	006
Apartment	117	Door	016	Heat	010	One	070	Station	156
Appliances	161	Down	008	Inside	209	Open	148	Storage	157
Area	118	Downstairs	184	Kitchen	022	Outside	210	Sun	154
Attic	119	Driveway	130	Laundry	140	Panic	013	System	062
Back	121	Duct	131	Left	027	Partition	090	Temperature	158
Bar	122	East	132	Light	019	Patio	149	Third	159
Basement	021	Eight	077	Living	030	Phone	061	Three	072
Bathroom	051	Eighth	221	Loading	142	Power	063	Tool	213
Battery	053	Equipment	133	Lower	094	Pump	166	Two	071
Bedroom	015	Exit	004	Machine	143	Rear	088	Up	025
Blower	123	Factory	134	Master	144	Right	028	Upper	187
Boiler	124	Fence	135	Medical	014	Room	018	Upstairs	183
Bright	162	Fifth	218	Motion	145	's	007	Utility	185
Building	125	Fire	040	Nine	078	Second	056	West	215
Burglary	039	First	136	Ninth	222	Service	150	Window	017
Central	089	Five	074	No	165	Seven	076	Wing	216
Chime	054	Floor	029	North	146	Seventh	220	Zero	069
Closed	126	Four	073	Not	012	Shed	151	Zone	002
Computer	127	Fourth	217			Shop	152		
Console	066	Foyer	137			Side	153		
Den	052	Front	087			Six	075		
Detector	128	Garage	023			Sixth	219		

Scheduled Check-in

The system can be programmed to call the downloader automatically, at a scheduled time. Once the connection is made, the downloader can perform any and all functions (arm, disarm, upload, etc.). The downloader determines the functions it performs.

To enter scheduled check-in, do the following:

1. From Data Field Programming mode, press **#93** to display the "ZONE PROG?" prompt.
2. Press **[0]** (NO) to each menu option until the "SCHEDULED CHK-IN" prompt is displayed.

PROMPT	EXPLANATION
SCHEDULED CHK-IN 1=YES 0=NO 0	Enter [1] at this prompt.
Chk-In Interval None 0	Enter the check-in interval. 0 = None; 1 = Weekly; 2 = Monthly; 3 = Quarterly; 4 = Yearly. Press [*] to accept entry.
DAY: M T W T F S S 1 2 3 4 5 6 7 1	If you selected 1 (weekly), the Day of the Week prompt is displayed. Enter the day of the week (1-7). Press [*] to accept entry and move to the Time of the Day prompt.
Quarter of Year JAN, APR, JUL, OCT 0	If you selected 3 (quarterly), the Quarter of the Year prompt is displayed. Enter the quarter of the year. 0 = January, April, July, and October; 1 = February, May, August, and November; 2 = March, June, September, and December. Press [*] to accept entry and move to the Day of the Month prompt.
Month of Year (01-12) 01	If you selected 4 (yearly), the Month of Year prompt is displayed. Enter the month (01-12). Press [*] to accept entry and move to the Day of the Month prompt.
Day of Month (01-28) 01	If you selected 2 (monthly), the Day of the Month prompt is displayed. Enter the day of the month (01-28). Press [*] to accept entry and move to the Time of the Day prompt.
Time of Day 12:00AM	The Time of the Day prompt is displayed. Enter the time of day for the check-in. Enter the hour of the day (01-12). Press [*] to accept entry. The cursor moves to the minutes position. (Press the [#] to move the cursor backwards.) Enter the minutes of the hour (00-59). Press [*] to accept entry. The cursor moves to the AM/PM position. Press [*] to accept the current selection or press any key (1-9) except the [*] or [#] to toggle the AM/PM selection. NOTE: The programming of field 1*71 determines the time of day format (12- or 24-hour).
QUIT MENU MODE? 1 = YES 0 = NO 0	Enter 1 to exit back to normal programming mode. Enter 0 to stay in menu mode.

System Layout Worksheets

Before programming any security system, you should first define the installation. To help you lay out a partitioned system, use the following worksheets. This will further simplify the programming process.

PARTITIONS

Partition #	Descriptor (4-char max)	Prim. Sub. #	Sec. Sub. #	Alpha Default Message (32-character maximum)
Partition 1				
Partition 2				
Partition 3				
Partition 4				
Partition 5				
Partition 6				
Partition 7				
Partition 8				
Keyswitch Arming Partition Assignment (1-8):				
Wireless Keypad Partition Assignment (1-8):				
Use Partition Descriptor (yes/no)?				
Common Lobby Partition Assignment (1-8):				

COMMUNICATION OPTIONS BY PARTITION

Option	Part. 1	Part. 2	Part. 3	Part. 4	Part. 5	Part. 6	Part. 7	Part. 8
Swinger Suppression Count 00-15; 00=no suppression								
Cancel Report After Disarm								
Dialer Reports for Panic (* + 1)								
Dialer Reports for Panic (# + 3)								
Dialer Reports for Panic (* + #)								
Dialer Reports for Duress								
Burglary Alarm Communications Delay (16 sec.)								

SYSTEM DEFINITIONS BY PARTITION (enter values or yes/no)

Option	Part. 1	Part. 2	Part. 3	Part. 4	Part. 5	Part. 6	Part. 7	Part. 8
Entry Delay #1 (00, 30-225 seconds):								
Exit Delay #1 (00, 45-225 seconds):								
Entry Delay #2 (00, 30-225 seconds):								
Exit Delay #2 (00, 45-225 seconds):								
Quick Arming								
Multiple Alarms per Arming								
Console Panic for Zone 995 (* + 1)								
Console Panic for Zone 996 (# + 3)								
Console Panic for Zone 999 (* + #)								
Allow Sign-on (GOTO function)								
Non-Bypassable Zone (001-128)								
Bell 1 Sounder Duration (2 min. increments)								
Bell 2 and Aux Relay Sounder Duration for (2 min. incr.)								
Console Annunciation During Entry (3 beeps or continuous)								
Console Annunciation During Exit								
Bell 1 Confirmation of Arming Ding								
Bell 2 and Aux Relay 1 Confirmation of Arming Ding								
Chime on Bell 1								
Chime on Bell 2 and Aux Relay								
Access Control Relay (field 1*76)								
Affects Lobby (check partitions that apply)								
Arms Lobby (check partitions that apply)								
Display Fire Alarms of Other Partitions								
Display Burg and Panic Alarms of Other Partitions								
Display Troubles of Other Partitions								

PRINTER OPTIONS

Parallel or Serial printer	
12- or 24-hour Time format	
Printer On-Line (yes/no)	
1200 or 300 baud Printer Baud Rate	

EVENT LOG TYPES

Option	No	Yes
Alarm		
Trouble		
Bypass		
Open/Close		
System		
Test		

DEVICES (keypads, 4204, rf receivers, communicator)

Addr	Type	Part	Sound Opt	Supv CF?	House ID	Kypd Gibal		Panel ID
00.								
01.								
02.								
03.								
04.								
05.								
06.								
07.								
08.								
09.								
10.								
11.								
12.								
13.								
14.								
15.								
16.								
17.								
18.								
19.								
20.								
21.								
22.								
23.								
24.								
25.								
26.								
27.								
28.								
29.								
30.								

Device Types:

00 = Device Not Used
01 = Alpha Console
03 = RF Receiver
04 = Output Relay Module
05 = Not Used
06 = Communicator
09 = Not Used
10 = Not Used

Console Sounder Options:

- 0 = No Suppression
- 1 = Suppress Arm/Disarm and Entry/Exit Beeps
- 2 = Suppress Chime Mode Beeps Only
- 3 = Suppress Arm/Disarm, Entry/Exit and Chime Mode Beeps

Defaults:

Addresses 00 = Alpha Keypad; No Suppression

ACCESS CODES and USER DEFINITIONS FOR PARTITIONS 1 and 2

[illegible]

ACCESS CODES and USER DEFINITIONS FOR PARTITIONS 3 and 4

4-digit Security Code	Access Group 0; 1-8	Partition 3						Partition 4					
		3-Digit User #	Auth. Level	Open/ Close	Group Bypass	RF Key	Global Arm	3-Digit User #	Auth. Level	Open/ Close	Group Bypass	RF Key	Global Arm

ACCESS CODES and USER DEFINITIONS FOR PARTITIONS 5 and 6

4-digit Security Code	Access Group 0; 1-8	Partition 5						Partition 6					
		3-Digit User #	Auth. Level	Open/ Close	Group Bypass	RF Key	Global Arm	3-Digit User #	Auth. Level	Open/ Close	Group Bypass	RF Key	Global Arm

ACCESS CODES and USER DEFINITIONS FOR PARTITIONS 7 and 8

4-digit Security Code	Access Group 0; 1-8	Partition 7						Partition 8					
		3-Digit User #	Auth. Level	Open/ Close	Group Bypass	RF Key	Global Arm	3-Digit User #	Auth. Level	Open/ Close	Group Bypass	RF Key	Global Arm

Authority Levels: 1=Master (arm, disarm, bypass, and/or modify lower level users)
 2=Manager (arm, disarm, bypass, and/or modify lower level users)
 3=Operator A (arm, disarm, bypass)
 4=Operator B (arm, disarm)
 5=Operator C (arm, disarm only if system was armed with this code)
 6=Duell code (arm, disarm, triggers silent panic alarm)

Defaults:

User	4-Digits	Alpha
User 1 (Installer)	5140	INSTLR
User 2	1234	MASTER

ZONE DEFINITION FOR ZONES 001-025

Zone No.	Zone Type	Part 1-8	Input Type	Arm w/Fault	Vent Zone	STAY Mode	Auto-STAY	Silent	Bypass Group	Access Point	Panel ID #	Tamper	Serial # / Loop	Bell/Relay Activation	Rpt. Code	Zone Information & Alpha Descriptor (3 words max.)
1																
2																
3																
4																
5																
6																
7																
8																
9																
10																
11																
12																
13																
14																
15																
16																
17																
18																
19																
20																
21																
22																
23																
24																
25																

ZONE DEFINITION FOR ZONES 026-050

Zone No.	Zone Type	Part 1-8	Input Type	Arm w/Fault	Vent Zone	STAY Mode	Auto-STAY	Silent	Bypass Group	Access Point	Panel ID #	Tamper	Serial # / Loop	Bell/Relay Activation	Rpt. Code	Zone Information & Alpha Descriptor (3 words max.)
26																
27																
28																
29																
30																
31																
32																
33																
34																
35																
36																
37																
38																
39																
40																
41																
42																
43																
44																
45																
46																
47																
48																
49																
50																

ZONE DEFINITION FOR ZONES 051-075

Zone No.	Zone Type	Part 1-8	Input Type	Arm w/Fault	Vent Zone	STAY Mode	Auto-STAY	Silent	Bypass Group	Access Point	Panel ID #	Tamper	Serial # / Loop	Bell/Relay Activation	Rpt. Code	Zone Information & Alpha Descriptor (3 words max.)
51																
52																
53																
54																
55																
56																
57																
58																
59																
60																
61																
62																
63																
64																
65																
66																
67																
68																
69																
70																
71																
72																
73																
74																
75																

ZONE DEFINITION FOR ZONES 076-100

Zone No.	Zone Type	Part 1-8	Input Type	Arm w/Fault	Vent Zone	STAY Mode	Auto-STAY	Silent	Bypass Group	Access Point	Panel ID #	Tamper	Serial # / Loop	Bell/Relay Activation	Rpt. Code	Zone Information & Alpha Descriptor (3 words max.)
76																
77																
78																
79																
80																
81																
82																
83																
84																
85																
86																
87																
88																
89																
90																
91																
92																
93																
94																
95																
96																
97																
98																
99																
100																

ZONE DEFINITION FOR ZONES 101-125

Zone No.	Zone Type	Part 1-8	Input Type	Arm w/Fault	Vent Zone	STAY Mode	Auto-STAY	Silent	Bypass Group	Access Point	Panel ID #	Tamper	Serial # / Loop	Bell/Relay Activation	Rpt. Code	Zone Information & Alpha Descriptor (3 words max.)
101																
102																
103																
104																
105																
106																
107																
108																
109																
110																
111																
112																
113																
114																
115																
116																
117																
118																
119																
120																
121																
122																
123																
124																
125																

ZONE DEFINITION FOR ZONES 126-128													
Zone No.	Zone Type	Part 1-8	Input Type	Arm w/Fault	Vent Zone	STAY Mode	Auto-STAY	Silent	Bypass Group	Access Point	Panel ID #	Tamper	Serial # / Loop
126													
127													
128													

ZONE DEFINITIONS FOR KEYPAD PANIC ZONES 995, 996, and 999

Zone No.	Zone Type	Enter yes/no for each partition-field *22								Bell/Relay Activation	Report Code	Zone Information and Alpha Descriptor (3 words max.)
		1	2	3	4	5	6	7	8			
995 (see note below)												
996												
999												

NOTE: Do Not Use Zone No. 995 in a Fire Alarm application.

ZONE DEFINITIONS FOR SYSTEM ZONES; 970 – 975, 988; 990 and 997

Zone No.	Zone Type	Bell/Relay Activation	Report Code	Zone Information and Alpha Descriptor (three words max.)
970				
971				
972				
973				
974				
975				
988				
990				
997				

ZONE DEFINITIONS FOR RELAY SUPERVISORY ZONES 601-632

Zone No.	Zone Type	Report Code	Zone Information and Alpha Descriptor (3 words max.)	Zone No.	Zone Type	Report Code	Zone Information and Alpha Descriptor (3 words max.)
601				617			
602				618			
603				619			
604				620			
605				621			
606				622			
607				623			
608				624			
609				625			
610				626			
611				627			
612				628			
613				629			
614				630			
615				631			
616				632			

NOTE: Only the relays on 4204CF modules may be supervised. If supervision is programmed for other types of Output Devices, unpredictable results may occur.

ZONE DEFINITIONS FOR SUPERVISORY OF ECP DEVICE ZONES 800-830

Zone No.	Zone Type	Report Code	Zone Information and Alpha Descriptor (3 words max.)	Zone No.	Zone Type	Report Code	Zone Information and Alpha Descriptor (3 words max.)
800				816			
801				817			
802				818			
803				819			
804				820			
805				821			
806				822			
807				823			
808				824			
809				825			
810				826			
811				827			
812				828			
813				829			
814				830			
815							

Zone Types			
00=zone not used	07=24-hour audible	16=fire w/verification	22=disarm
01=entry/exit 1	08=24-hour auxiliary	17=waterflow	23=no alarm response
02=entry/exit 2	09=supervised fire	18=supervisory	27=Not Used
03=perimeter	10=interior (delay)	19=24-hour trouble	28=Not Used
04=interior (follower)	12=Not Used	20=arm stay	29=Not Used
05=day/night burglary	13=Remote P/S	21=arm away	
06=24-hour silent	14=CO Detector alarm		

Input Types		Bells/Auxiliary Relay Activation	
00=not used	07=Dip switch-type polling loop	0=none	4=auxiliary relay
01=hardwired	08=right loop dip switch poll loop	1=bell 1	5=bell 1 and auxiliary relay
02=RF motion transmitter	09=keypad input	2=bell2	6=bell 2 and auxiliary relay
03=supervised RF transmitter	10=Not Used	3=bells 1 and 2	7=bells 1 and 2 and auxiliary relay
04=unsupervised RF transmitter	11=Not Used		
05=RF button transmitter	12=Not Used		
06=serial number polling loop	13=Not Used		

Output Devices Worksheets

Applicable only if relays (4204/4204CF) or V-Plex are used.

Output Devices – Programmed in the #93 Menu Mode in the Output Programming Section. Fill in the required data on the worksheet below and follow the procedure in the installation instructions as you enter the data during the displays and prompts that appear in sequence.

- NOTES:**
1. For 4204/4204CF, the Device Programming section must be programmed for the device address. Set the DIP switches on the device for that address.
 2. For V-Plex, devices must be programmed in the Zone Programming section
 3. If you are using outputs on V-Plex (e.g., 4101SN) no more than 20 of the V-Plex outputs may be programmed for the same START or STOP condition. Also, if you are using ZONE # for the START of a V-Plex output and want that output to stop when the same zone restores, the STOP programming **MUST BE BLANK**.

OUTPUT DEV #	A	S T A R T					S T O P			Relay Group	Restrict	0=V-Plex 1=4204/ 4204CF	V-Plex Zone # or Dev Add 4204/4204CF	Relay # for 4204/ 4204CF
		EV/ZL	Zone	ZT / P	ZL	ZT / P								
1														
2														
3														
4														
5														
6														
7														
8														
9														
10														
11														
12														
13														
14														
15														
16														
17														
18														
19														
20														

OUTPUT DEVICES WORKSHEET (cont'd)

OUTPUT DEV #	A	S T A R T					S T O P			Relay Group	Restrict	0=V-Plex 1=4204/ 4204CF	V-Plex Zone # or Dev Add 4204/4204CF	Relay # for 4204/ 4204CF
		EV/ZL		Zone	ZT / P		ZL	ZT / P						
21														
22														
23														
24														
25														
26														
27														
28														
29														
30														
31														
32														
33														
34														
35														
36														
37														
38														
39														
40														
41														
42														
43														
44														
45														

OUTPUT DEVICES WORKSHEET (cont'd)

OUTPUT DEV #	A	S T A R T					S T O P			Relay Group	Restrict	0=V-Plex 1=4204/ 4204CF	V-Plex Zone # or Dev Add 4204/4204CF	Relay # for 4204/ 4204CF
		EV/ZL	Zone	ZT / P	ZL	ZT / P								
46														
47														
48														
49														
50														
51														
52														
53														
54														
55														
56														
57														
58														
59														
60														
61														
62														
63														
64														
65														
66														
67														
68														
69														
70														

OUTPUT DEVICES WORKSHEET (cont'd)

OUTPUT DEV #	A	S T A R T					S T O P			Relay Group	Restrict	0=V-Plex 1=4204/ 4204CF	V-Plex Zone # or Dev Add 4204/4204CF	Relay # for 4204/ 4204CF
		EV/ZL		Zone	ZT / P		ZL	ZT / P						
71														
72														
73														
74														
75														
76														
77														
78														
79														
80														
81														
82														
83														
84														
85														
86														
87														
88														
89														
90														
91														
92														
93														
94														
95														
96														

0 = No Response; 1 = Close for 2 sec; 2 = Close and stay closed; 3 = Pulse on and off; 4 = Toggle alternately between START and STOP events

0 = Not used; 1 = Alarm; 2 = Fault; 3 = Trouble; 4 = Restore

01-15. 00 = Not Used

"START" ZONE LIST: Upon alarm, fault, trouble or restore of ANY zone in this list, device action will START.

"STOP" ZONE LIST: Upon restore of ALL zones on this list, device action will STOP. It need not be same list as used for START.

Choices for Zone Type/System Operation are:

00 = No Response (Not Used)	21 = Arming-AWAY****	41 = AC Power Fail
01 = Entry/Exit #1	22 = Disarming (Code + Off)	42 = System Battery Low
02 = Entry/exit #2	23 = No Alarm Response	43 = Communication failure
03 = Perimeter	27 = Access Point (allows more than one relay to be controlled by activation if access point request) - Not Used	44 = RF Low Battery
04 = Interior Follower	28 = MLB Supervision - Not Used	45 = Polling Loop Failure
05 = Trouble Day/Alarm Night	29 = Momentary Exit - Not Used	47 = Console Failure
06 = 24-Hr. Silent	30 = On Second Code + Off	51 = RF Receiver Failure
07 = 24-Hr. Audible	31 = End of Exit Time	52 = Kissoff
08 = 24-Hr. Auxiliary	32 = Start of Entry Time	54 = Fire Zone Reset
09 = Fire Alarm or Trouble	33 = Any Burglary Alarm	55 = Disarm + 1 Minute
10 = Interior W/Delay		56 = XX Minutes (enter XX in field 1*74) *
12 = PLM Supervision - Not Used		57 = YY Seconds (enter YY in field 1*75) *
13 = Remote P/S	34 = Code + [#] + 71	58 = Duress
14 = CO Detector Alarm	35 = Code + [#] + 72	60 = Audio Alarm Verification (must be selected for both START and STOP operation)
16 = Fire With Verification	36 = At Bell Timeout **	
17 = Waterflow*****	37 = 2 Times Bell Timeout **	61 = Code + [#] + 67
18 = Fire Supervisory	38 = Chime	62 = Bell 2 Timeout
19 = 24-Hour Trouble	39 = Fire Alarm	63 = Auxiliary Relay Timeout
20 = Arming-STAY***	40 = Bypassing	

* Stop condition only

** Or at disarming, whichever occurs earlier

*** The output also activates when the partition is armed in the INSTANT mode

**** The output also activates when the partition is armed in the MAXIMUM mode

***** Use an event of fault or alarm as the START option

ZONE LISTS FOR OUTPUT DEVICES – Programmed in the #93 Menu Mode in the Output Programming Section. Fill in the required data on the worksheet below and follow the procedure shown earlier in this *Programming Guide* as you enter the data during the displays and prompts that appear in sequence. Up to 15 zone lists may be created

NOTE:Record desired zone numbers below. More or fewer boxes than shown may be needed, as any list may include *any* or *all* of system's zone numbers.

Zone List 1: Started or stopped by zone numbers (enter 000 to end entries).

[illegible]

Zone List 2: Started or stopped by zone numbers (enter 000 to end entries).

[illegible]

Zone List 3: Started or stopped by zone numbers (enter 000 to end entries).

[illegible]

Zone List 4: Started or stopped by zone numbers (enter 000 to end entries).

[illegible]

Zone List 5: Started or stopped by zone numbers (enter 000 to end entries).

<input type="text"/>	<input type="text"/>	<input type="text"/>	<input type="text"/>	<input type="text"/>	<input type="text"/>	<input type="text"/>
<input type="text"/>	<input type="text"/>	<input type="text"/>	<input type="text"/>	<input type="text"/>	<input type="text"/>	<input type="text"/>

Zone List 6: Started or stopped by zone numbers (enter 000 to end entries).

<input type="text"/>	<input type="text"/>	<input type="text"/>	<input type="text"/>	<input type="text"/>	<input type="text"/>	<input type="text"/>
<input type="text"/>	<input type="text"/>	<input type="text"/>	<input type="text"/>	<input type="text"/>	<input type="text"/>	<input type="text"/>

Zone List 7: Started or stopped by zone numbers (enter 000 to end entries).

<input type="text"/>	<input type="text"/>	<input type="text"/>	<input type="text"/>	<input type="text"/>	<input type="text"/>	<input type="text"/>
<input type="text"/>	<input type="text"/>	<input type="text"/>	<input type="text"/>	<input type="text"/>	<input type="text"/>	<input type="text"/>

Zone List 8: Started or stopped by zone numbers (enter 000 to end entries).

<input type="text"/>	<input type="text"/>	<input type="text"/>	<input type="text"/>	<input type="text"/>	<input type="text"/>	<input type="text"/>
<input type="text"/>	<input type="text"/>	<input type="text"/>	<input type="text"/>	<input type="text"/>	<input type="text"/>	<input type="text"/>

Zone List 9: Started or stopped by zone numbers (enter 000 to end entries).

<input type="text"/>	<input type="text"/>	<input type="text"/>	<input type="text"/>	<input type="text"/>	<input type="text"/>	<input type="text"/>
<input type="text"/>	<input type="text"/>	<input type="text"/>	<input type="text"/>	<input type="text"/>	<input type="text"/>	<input type="text"/>

Zone List 10: Started or stopped by zone numbers (enter 000 to end entries).

<input type="text"/>	<input type="text"/>	<input type="text"/>	<input type="text"/>	<input type="text"/>	<input type="text"/>	<input type="text"/>
<input type="text"/>	<input type="text"/>	<input type="text"/>	<input type="text"/>	<input type="text"/>	<input type="text"/>	<input type="text"/>

Zone List 11: Started or stopped by zone numbers (enter 000 to end entries).

<input type="text"/>	<input type="text"/>	<input type="text"/>	<input type="text"/>	<input type="text"/>	<input type="text"/>	<input type="text"/>
<input type="text"/>	<input type="text"/>	<input type="text"/>	<input type="text"/>	<input type="text"/>	<input type="text"/>	<input type="text"/>

Zone List 12: Started or stopped by zone numbers (enter 000 to end entries).

<input type="text"/>	<input type="text"/>	<input type="text"/>	<input type="text"/>	<input type="text"/>	<input type="text"/>	<input type="text"/>
<input type="text"/>	<input type="text"/>	<input type="text"/>	<input type="text"/>	<input type="text"/>	<input type="text"/>	<input type="text"/>

Zone List 13: Started or stopped by zone numbers (enter 000 to end entries).

<input type="text"/>	<input type="text"/>	<input type="text"/>	<input type="text"/>	<input type="text"/>	<input type="text"/>	<input type="text"/>
<input type="text"/>	<input type="text"/>	<input type="text"/>	<input type="text"/>	<input type="text"/>	<input type="text"/>	<input type="text"/>

Zone List 14: Started or stopped by zone numbers (enter 000 to end entries).

<input type="text"/>	<input type="text"/>	<input type="text"/>	<input type="text"/>	<input type="text"/>	<input type="text"/>	<input type="text"/>
<input type="text"/>	<input type="text"/>	<input type="text"/>	<input type="text"/>	<input type="text"/>	<input type="text"/>	<input type="text"/>

Zone List 15: Started or stopped by zone numbers (enter 000 to end entries).

<input type="text"/>	<input type="text"/>	<input type="text"/>	<input type="text"/>	<input type="text"/>	<input type="text"/>	<input type="text"/>
<input type="text"/>	<input type="text"/>	<input type="text"/>	<input type="text"/>	<input type="text"/>	<input type="text"/>	<input type="text"/>

Scheduling Menu Prompts

To program schedules, enter Scheduling program mode by pressing **[User Code] + # + 80** to display the first choice of the menu driven programming functions. **NOTE:** Only users with an Installer or Master level user code may enter the #80 mode. Press **0** (NO) or **1** (YES) in response to the displayed menu selection. Pressing **0** will display the next choice in sequence. Menu selections are as follows:

PROMPT	EXPLANATION
Time Window ? 1 = YES 0 = NO 0	For defining up to 20 time windows each with a start and a stop time programmed by entering the hours and minutes.
O/C Schedules ? 1 = YES 0 = NO 0	For defining the daily open and close schedules for the 8 partitions. Each partition can be programmed with an opening and closing window for each day of the week and holidays.
Holidays ? 1 = YES 0 = NO 0	For defining up to 16 holidays for which partitions they apply.
Timed Events ? 1 = YES 0 = NO 0	For defining up to 20 time driven events with the following parameters: <ul style="list-style-type: none"> • Time window • Action desired • Action specifier • Activation time • Days of the week
Access Sched. ? 1 = YES 0 = NO 0	For defining the limitation of access schedules for the user codes. Each schedule can be programmed with two window for each day of the week and holidays

#80 and #81 MENU MODE KEY COMMANDS

The following is a list of commands used while in the Menu mode.

#80 or #81	Enters Menu mode
[Q]	Serves as ENTER key. Press to have keypad accept entry.
[#]	Backs up to previous screen.
0	Press to answer NO.
1	Press to answer YES.
01-09	All data entries are either 2-digit entries.
00	Exits Menu mode, returns to normal operation mode when entered at the first question for each category.

Scheduling Worksheets

Time Windows Definitions Worksheet. The system provides 20 time windows that are defined with start and stop times. They are programmed in the #80 Menu Mode. Fill in the required data on the worksheet below and follow the procedure in the installation instructions as you enter the data during the displays and prompts that appear in sequence.

Time Window Number	Start Time (HH:MM)	Stop Time (HH:MM)
1		
2		
3		
4		
5		
6		
7		
8		
9		
10		
11		
12		
13		
14		
15		
16		
17		
18		
19		
20		

(Keep this worksheet handy, as you will be asked for a given time window number later in this section).



Because the time windows are shared among all partitions, it is important to make sure that changing a time window does not adversely affect desired actions in other partitions.

Daily Open/Close Schedule Worksheet: Using the time windows previously defined, fill in the required data on the worksheet below and follow the procedure in the installation instructions as you enter the data during the displays and prompts that appear in sequence.

Part	Mon		Tues		Wed		Thur		Fri		Sat		Sun		Hol	
	Op	Cl	Op	Cl	Op	Cl	Op	Cl	Op	Cl	Op	Cl	Op	Cl	Op	Cl
1																
2																
3																
4																
5																
6																
7																
8																

Holiday Schedule Worksheet: The system provides up to 16 holidays that can be assigned for the system. Each holiday can be assigned to any combination of partitions. Fill in the required data on the worksheet below and follow the procedure in the installation instructions as you enter the data during the displays and prompts that appear in sequence.

HOL	Partition								
	Month/Day	1	2	3	4	5	6	7	8
1	/								
2	/								
3	/								
4	/								
5	/								
6	/								
7	/								
8	/								
9	/								
10	/								
11	/								
12	/								
13	/								
14	/								
15	/								
16	/								

Time-Driven Event Worksheet: The system provides up to 20 time-driven events that can be programmed for the system. Fill in the required data on the worksheet below and follow the procedure in the installation instructions as you enter the data during the displays and prompts that appear in sequence.

Sched Num.	Time Window	Day(s)									Action Desired	Action Specifier	Activation Time
		M	T	W	T	F	S	S	H				
1													
2													
3													
4													
5													
6													
7													
8													
9													
10													
11													
12													
13													
14													
15													
16													
17													
18													
19													
20													

Automatic Refresh: The system automatically updates the status of all Time-Driven Events upon any of the following occurrences:

- Changing of the time or date via #63 mode
- Exiting #80 Scheduling Menu mode
- Exiting Program mode
- After a disconnect from the downloader
- On a power-up
- At Daylight Saving Time adjustment.

Below is a list of the "Action" codes (desired actions) used when programming time-driven events. Note that these codes are independent of the "relay codes" programmed during the #93 Menu Mode—Output Programming mode. **If using Time Driven Events, the following menu items must first be programmed using #93 Menu Mode - Output Programming:**

Enter Relay No.	(reference identification number)	Zone No.	(V-Plex)
Relay Group	(if applicable)	ECP Address	(4204/4204CF)
Restriction		Relay No.	(4204/4204CF)
Relay Type	(V-Plex or 4204/4204CF)		

Relay commands:

Action Specifier for commands 01-05 is Relay No.; Action Specifier for commands 06-10 is Relay Group No.

- | | |
|--|--|
| 01 = Relay On | 02 = Relay Off |
| 03 = Relay Close for 2 seconds | 04 = Relay Close XX minutes (field 1*74) |
| 05 = Relay Close YY seconds (field 1*75) | 06 = Relay Group On |
| 07 = Relay Group Off | 08 = Relay Group Close for 2 seconds |
| 09 = Relay Group Close XX minutes (field 1*74) | 10 = Relay Group Close YY seconds (field 1*75) |

Arm/Disarm commands:

Action Specifier for commands 20-24 is Partition(s). Activation times 1 (Beginning), 2 (End), 3 (During), 5 (Random Start), 6 (Random End), 7 (Random During) are the only valid choices for auto-arming and disarming functions.

- | | |
|---|---|
| 20 = Arm-Stay | 21 = Arm Away |
| 22 = Disarm | 23 = Force Arm Stay (Auto-bypass faulted zns) |
| 24 = Force Arm Away (Auto-bypass faulted zns) | 25 = Arm Instant |
| 26 = Arm Maximum | |

Bypass commands:

Action Specifier for commands 30-31 is Zone List #, Activation times 1 (Beginning), 2 (End), 3 (During), 5 (Random Start), 6 (Random End), 7 (Random During) are the only valid choices for bypass commands.

- | | |
|------------------------------|--------------------------------|
| 30 = Auto bypass - Zone list | 31 = Auto unbypass - Zone list |
|------------------------------|--------------------------------|

Open/Close Windows:

Action Specifier for commands 40-41 is Partition(s), for 42 is Access Group and for 50 no specifier is programmed.

Activation time 3 (During), 7 (Random During) are the only valid choices for these commands.

- | | | |
|---|----------------------------|---------------------------|
| 40 = Enable Opening Window | 41 = Enable Closing Window | 42 = Enable Access Window |
| 50 = Off-Normal Reminder (Starts local keypad beeping if off-normal condition exists) | | |

Additional Commands

Action Specifier for command 78 is Group.

- 78 = Access Point Group Disable

Activation time:

Refers to when the action is to take place relative to the time window.

1 = Beginning of time window

4 = Beginning and end of time window

2 = End of time window

5 = Random Start of the time window *

3 = During time window active period only (On at beginning of window, off at end).

6 = Random End of the time window *

7 = Random During the time window *

* The activation time of the window is randomized up to 30 minutes and is initialized by either of two methods:

a. **[User Code] + [#] + [41]** – Initiates the random schedule for all devices in the partition.

b. **[User Code] + [#] + [42]** – Initiates the random schedule for all devices in the partition with a time window within 6 PM and 5 AM.

Limitation of Access Worksheet The system provides up to 8 Access Schedules that can be programmed for the system. Fill in the required data on the worksheet below and follow the procedure in the installation instructions as you enter the data during the displays and prompts that appear in sequence.

Acc Sch	Mon		Tues		Wed		Thurs		Fri		Sat		Sun		Hol	
	W1	W2	W1	W2	W1	W2	W1	W2	W1	W2	W1	W2	W1	W2	W1	W2
1																
2																
3																
4																
5																
6																
7																
8																

Temporary Schedule #81 Menu Mode. The system provides a Temporary Schedule for each partition. Enter the temporary scheduling mode by pressing **[Installer Code] + [#] + [81]**. Fill in the required data on the worksheet below and follow the procedure in the installation instructions as you enter the data during the displays and prompts that appear in sequence.

Partition/Windows		Mon	Tue	Wed	Thu	Fri	Sat	Sun
1	Disarm Window							
	Start Time HH:MM							
	Stop Time HH:MM							
	Arm Window							
	Start Time HH:MM							
	Stop Time HH:MM							
2	Disarm Window							
	Start Time HH:MM							
	Stop Time HH:MM							
	Arm Window							
	Start Time HH:MM							
	Stop Time HH:MM							

Partition/Windows		Mon	Tue	Wed	Thu	Fri	Sat	Sun
3	Disarm Window							
	Start Time HH:MM							
	Stop Time HH:MM							
	Arm Window							
	Start Time HH:MM							
	Stop Time HH:MM							
4	Disarm Window							
	Start Time HH:MM							
	Stop Time HH:MM							
	Arm Window							
	Start Time HH:MM							
	Stop Time HH:MM							
5	Disarm Window							
	Start Time HH:MM							
	Stop Time HH:MM							
	Arm Window							
	Start Time HH:MM							
	Stop Time HH:MM							
6	Disarm Window							
	Start Time HH:MM							
	Stop Time HH:MM							
	Arm Window							
	Start Time HH:MM							
	Stop Time HH:MM							
7	Disarm Window							
	Start Time HH:MM							
	Stop Time HH:MM							
	Arm Window							
	Start Time HH:MM							
	Stop Time HH:MM							
8	Disarm Window							
	Start Time HH:MM							
	Stop Time HH:MM							
	Arm Window							
	Start Time HH:MM							
	Stop Time HH:MM							

NOTES

NOTES

COMMERCIAL FIRE AND BURGLAR ALARM PROTECTED PREMISES CONTROL UNIT

FOR DRY, INDOOR USE ONLY

WARNING:

This unit includes a Fire Alarm Verification feature that will result in a delay of the System Alarm Signal from the indicated Fire Alarm circuits. The total delay (Control Unit plus Smoke Detectors) shall not exceed 30 seconds. No other Smoke Detector shall be connected to these circuits unless approved by the local authority having jurisdiction.

Circuit (zone)	Control Unit Delay, Seconds	Smoke Detector Model	Delay, Seconds
Zone 1	8 Seconds		
Zone 2	8 Seconds		
Aux Relay	8 Seconds		

THE DELAY TIME MARKED ON THE INSTALLED DETECTOR(S) IS TO BE USED.

This equipment should be installed in accordance with the National Fire Protection Association's Standard 72 (National Fire Protection Assoc., Batterymarch Park, Quincy, MA, 02169). Printed information describing proper installation, operation, testing, maintenance and repair service is to be provided with this equipment.

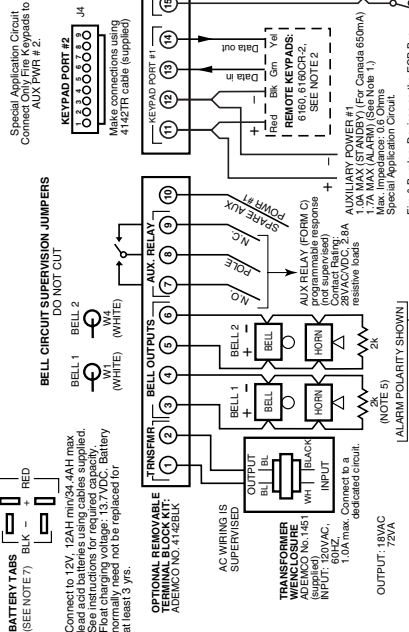

- NOTES**
- The combined standby current drawn from aux pwr #1, aux pwr #2 and polling loop shall not exceed 7.4mA. The combined alarm current drawn from aux pwr #1, aux pwr #2, polling loop, bell 1 and bell 2 shall not exceed 2.3A (for Canada, 1.95A).
 - See instructions on setting addresses & for restrictions on jumpers and wire run length.
 - Use only 14-22 AWG wire.
 - No more than one (1) wire per terminal may be connected.
 - Maximum Loop Impedance is 1.17 Ohms.
 - 2k EOLR is Ademco Model EOL20.
 - If supervision of the batteries is required, they must be supervised by the Battery Sense Module. The Battery Sense Module is then connected to the panel. Refer to the Battery Sense Module instructions for connections.

TEST BURGLARY SYSTEM WEEKLY

TYPES OF FIRE SIGNALING SERVICE:
Manual fire alarm, automatic fire alarm, sprinkler supervisory and waterflow alarm, DACT, Radio Frequency (RF) and Multiplex.
UL Listed local control (non-coded), UL Listed central station and remote station protected premises unit when used with 5140DLR back-up daller module. Installation into under jurisdiction of local authority.

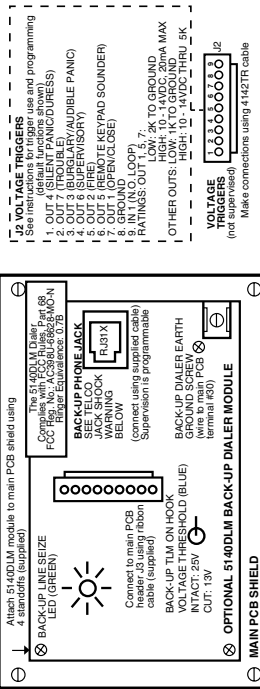

14 KEYPAD PORT #2
See instr. regarding port #2 use
1. DATA IN (2 to keypad green wire)
2. DATA IN (2 to keypad green wire)
3. DATA IN (2 to keypad green wire)
4. DATA IN (2 to keypad green wire)
5. AUX PWR #2 (to keypad green wire)
6. AUX PWR #2 (to keypad green wire)
7. DATA OUT (2 to keypad yellow wire)
8. DATA OUT (2 to keypad yellow wire)
9. DATA OUT (2 to keypad yellow wire)
10. DATA OUT (2 to keypad yellow wire)
11. DATA OUT (2 to keypad yellow wire)
12. DATA OUT (2 to keypad yellow wire)
13. DATA OUT (2 to keypad yellow wire)
14. DATA OUT (2 to keypad yellow wire)

CONNECTION OF THE FIRE ALARM SIGNAL TO A FIRE ALARM HEAD:
See instructions for fire alarm head. THE APPROVAL OF THE LOCAL AUTHORITY HAVING JURISDICTION, SHALL NOT BE CONNECTED TO A POLICE EMERGENCY NUMBER.

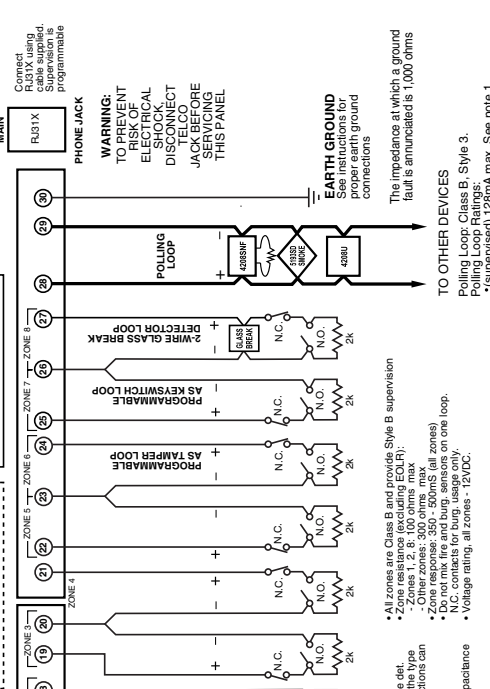

14 KEYPAD PORT #2
See instr. regarding port #2 use
1. DATA IN (2 to keypad green wire)
2. DATA IN (2 to keypad green wire)
3. DATA IN (2 to keypad green wire)
4. DATA IN (2 to keypad green wire)
5. AUX PWR #2 (to keypad green wire)
6. AUX PWR #2 (to keypad green wire)
7. DATA OUT (2 to keypad yellow wire)
8. DATA OUT (2 to keypad yellow wire)
9. DATA OUT (2 to keypad yellow wire)
10. DATA OUT (2 to keypad yellow wire)
11. DATA OUT (2 to keypad yellow wire)
12. DATA OUT (2 to keypad yellow wire)
13. DATA OUT (2 to keypad yellow wire)
14. DATA OUT (2 to keypad yellow wire)

CONNECTION OF THE FIRE ALARM SIGNAL TO A FIRE ALARM HEAD:
See instructions for fire alarm head. THE APPROVAL OF THE LOCAL AUTHORITY HAVING JURISDICTION, SHALL NOT BE CONNECTED TO A POLICE EMERGENCY NUMBER.

FOR INSTRUCTIONS:
SEE INSTRUCTIONS
SECTION 4-10

The Main Panel, Compatible with FCC Rules Part 68
FCC Reg. No.: AC2-USA48192-ALE
Finger Evidence: 0.75

ZONE INPUT SPECIFICATIONS

ZONE 2-7 EOLR CNFG.	ZONE 8	ZONE 9
• Maximum Loop Current (short loop): 7.4mA • Maximum Loop V: 13.3VDC • Loop Short: 0V - 1.5V - 300 ohms total resistance • Loop Normal: 4.2 - 6.8V - 1.2k - 2.6k • Loop Open: 7.2V - 13.3V 3k - ∞	• Maximum Loop Current (short loop): 7.4mA • Maximum Loop V: 13.3VDC • Loop Short: 0V - 2.2V - (0 - 300 ohms) • Loop Normal: 4.2 - 6.8V - 1.2k - 2.6k • Loop Open: 7.2V - 13.3V 3k - ∞	• Maximum Loop Current (short loop): 7.4mA • Maximum Loop V: 13.3VDC • Loop Short: 0V - 2.2V - (0 - 300 ohms) • Loop Normal: 4.2 - 6.8V - 1.2k - 2.6k • Loop Open: 7.2V - 13.3V 3k - ∞

VISTA-128FBPN SUMMARY OF CONNECTIONS

V128FBPN-SOC-V1

ASSEMBLED IN MEXICO

Honeywell

2 Corporate Center Drive, Suite 100
P.O. Box 9040, Melville, NY 11747
Copyright © 2010 Honeywell International Inc.

www.honeywell.com/security



800-06308 4/10 Rev. B